



Kingfishers

Mill House Lane | Addington | West Malling | ME19 5BA

Stuart Reynolds
POWERED BY
exp



Summary

Coming in at just over 3,200sqft, the accommodation to this detached residence is not just vast but equally very versatile as the layout lends itself to be used in a variety of ways. Boasting five core bedrooms, there is the ability to create a further two bedrooms if so required whilst still maintaining vital additional rooms for those who need office space to work from home.

The modern, open plan kitchen/dining room is an ideal central hub and a perfect, sociable space when entertaining with friends and relatives. The 19'8" living room presides over the front lawn and sun terrace and a further three reception rooms plus cloakroom, complete the ground floor. Three double bedrooms are located on the first floor along with an en suite and family bathroom. There is another separate floor, accessed via the rear lobby and its own stairway which hosts two more bedrooms and shower room.

Located at the end of Mill House Lane, the home is approached via a long, private driveway with lawned garden to one side and large pond to the other. The parking area caters for multiple vehicles in addition to a detached double garage. An extensive garden area is at the rear and overall, the plot is estimated to be in the region of 1.73 acres.

Within easy reach of the thriving market Town of West Malling, the picturesque village of Addington continues to be an exceptional location, highly sought after and with tree lined roads, its own local pub/restaurant (The Angel Inn), family run golf club that boasts not one but two 18 hole courses and proximity to a host of travel connections, it is easy to understand why.



Accommodation

Ground Floor

Entrance Hallway

Cloakroom

Living Room - 19'8 x 18'1

Dining Room - 15'5 x 10'2

Kitchen/Dining Room - 26'3 x 21'4

Study - 10'10 x 10'6

Reception/Gym - 10'2 x 9'6

Rear Lobby

First Floor

Landing

Master Bedroom - 21'4 x 14'9

En Suite

Bedroom Two - 16'5 x 9'10

Bedroom Three - 13'9 x 8'2

Bathroom

Separate First Floor

Landing

Bedroom Four - 14'1 x 9'6

Bedroom Five - 12'6 x 8'2

Shower Room

Second Floor

Loft Room - 19 x 9'6

Outside

Large Driveway/Parking Area Plus Double Garage

Extensive Grounds Estimated In The Region Of 1.73acres



GROUND FLOOR



1ST FLOOR

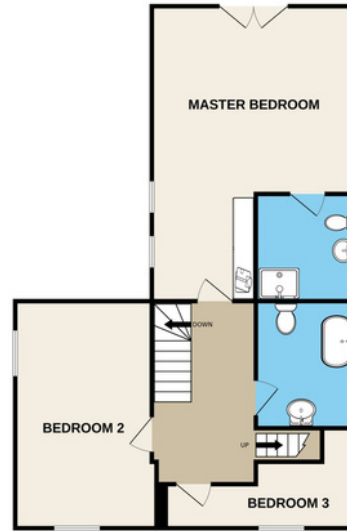

2ND FLOOR



2ND FLOOR (LOFT ROOM)

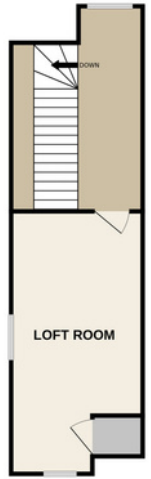

STUART REYNOLDS

POWERED BY
exp™ UK

01732 647009 stuart.reynolds@exp.uk.com



@sreynoldsrealestate