



HENRY  **WILTSHIRE**

www.henrywiltshire.co.uk

Henry Wiltshire Limited Company Registration No. 07120440 VAT Registration No. 994 397 354

Registered Office: 2 Laybourne House, Admirals Way, Canary Wharf, London, United Kingdom E14 9UH

Wards Wharf Approach, London, E16 2EQ

Offers Over £417,500

🛏️ 2 🚿 2 🛋️ 1



- 3rd Floor Two Bedroom Apartment
- New Kitchen
- River Views
- Secure Parking
- Chain Free
- Two New Bathrooms
- Private Balcony
- Residents Gym
- 24 Hour Concierge
- Easy Access To London City Airport



Absolutely superb two bedroom, two bathroom apartment set in the Tradewinds development close to City Airport and the DLR.

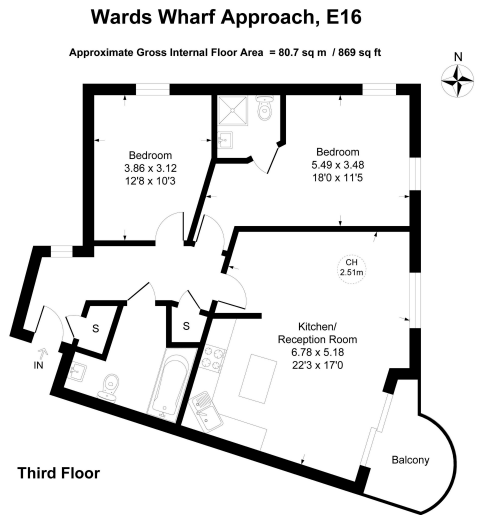

Illustration for identification purposes only, measurements are approximate, not to scale.

Energy Efficiency Rating		
	Current	Potential
Very energy efficient - lower running costs		
(92 plus) A		
(81-91) B	82	83
(69-80) C		
(55-68) D		
(39-54) E		
(21-38) F		
(1-20) G		
Not energy efficient - higher running costs		
England & Wales	EU Directive 2002/91/EC	

UK Offices | Canary Wharf - E14 | Nine Elms - SE1 | Royal Docks - E16 | Bow - E3 | Hayes, Middlesex - UB3 | Manchester - M2

International Offices | Dublin | Abu Dhabi | Hong Kong | Singapore

