



24 Downfield Walk, Plympton, Plymouth, Devon, PL7 2DT



Price £175,000

Being sold with vacant possession and no onward chain, is this 2-bedroom semi-detached bungalow.

Needing complete renovation, the property offers a potential purchaser the opportunity to add their own stamp but does benefit from UPVC double glazing and gas central heating.

The accommodation has a lounge/diner, kitchen, 2 double bedrooms and a three-piece bathroom suite. There are gardens front and rear, and a storage shed.

This residence is ideally positioned to the Ridgeway Shopping Centre in Plympton which offers numerous shops and facilities. Doctor's and dental surgeries can be found close by. Transport links connect you to all the surrounding areas including the vibrant city centre of Plymouth. This residence is ideally positioned to the Ridgeway Shopping Centre in Plympton which offers numerous shops and facilities. Doctor's and dental surgeries can be found close by. Transport links connect you to all the surrounding areas including the vibrant city centre of Plymouth.



To view this property call Lang Town & Country Estate Agents on **01752 456000**

www.langtownandcountry.com



GROUND FLOOR
594 sq.ft. (55.2 sq.m.) approx.

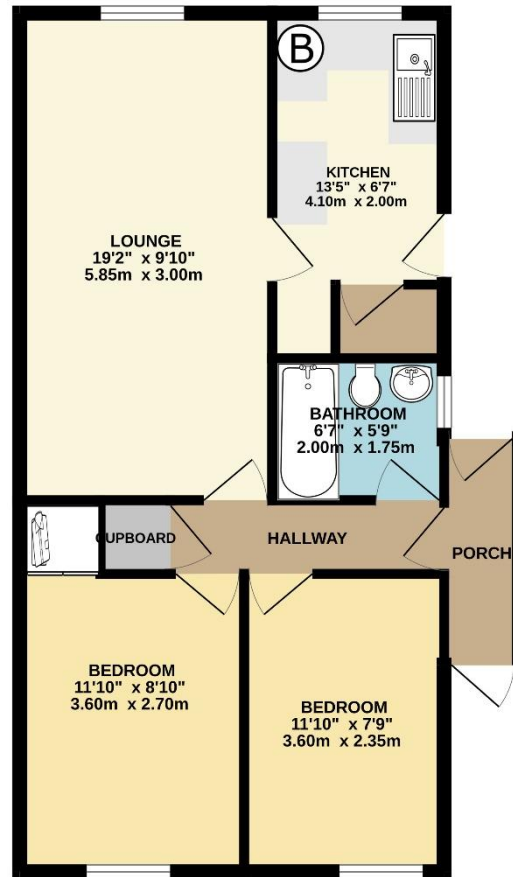

TOTAL FLOOR AREA : 594 sq.ft. (55.2 sq.m.) approx.
Measurements are approximate. Not to scale. Illustrative purposes only
Made with Metropix ©2024

Lang Town & Country
6 The Broadway
Plymouth
PL9 7AU
Tel: 01752 456000
Email: plymstock@langtownandcountry.com
www.langtownandcountry.com

Lang Town & Country endeavour to ensure the accuracy of property details produced and displayed, we have not tested any apparatus, equipment, fixtures, fittings or services and so cannot verify that they are connected, in working order or fit for purpose. A buyer must check the availability of any property and make an appointment to view before embarking on any journey to see a property.

