



65 Laira Park Road, Lipson, Plymouth, PL4 7HR

Price £175,000



Lang Town and Country are delighted to introduce to the market this two-bedroom semi-detached bungalow offering picturesque views of the playing fields opposite. Perfectly positioned at the end of a quiet, no through road this hidden gem awaits transformation, presenting a blank canvas for internal renovations.

The property is situated in the popular residential area of Laira with easy access onto the nearby A38 and regular bus routes to the City Centre.

The accommodation comprises a sitting room with French doors, kitchen, two double bedrooms, bathroom and a conservatory. Modern benefits include uPVC double glazing but there is no gas or electric heating.

Externally the property boasts a gated driveway for vehicular access, while the rear garden is a blank canvas with a shed and small greenhouse. A unique opportunity, this chain-free bungalow invites you to reimagine its potential and create your dream home.



To view this property call Lang Town & Country Estate Agents on **01752 256000**

www.langtownandcountry.com



GROUND FLOOR
565 sq.ft. (52.5 sq.m.) approx.

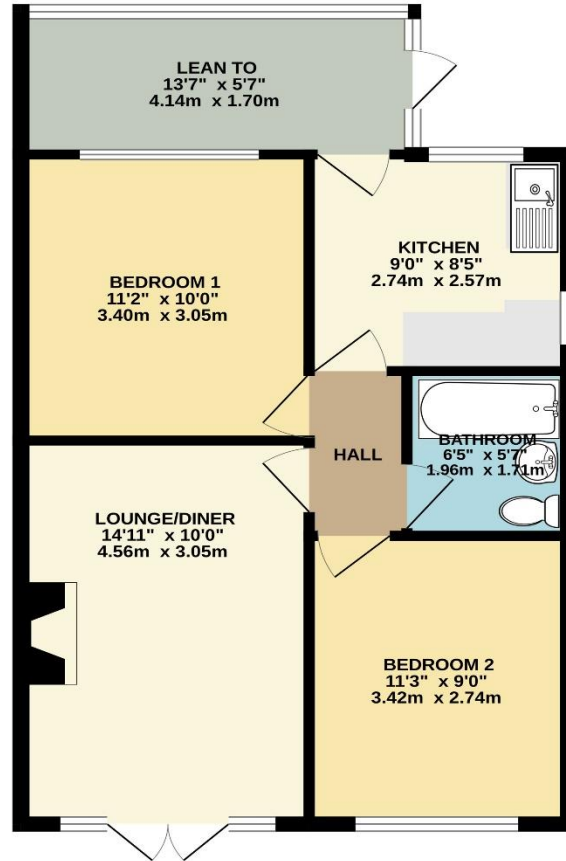

TOTAL FLOOR AREA : 565 sq.ft. (52.5 sq.m.) approx.
Whilst every attempt has been made to ensure the accuracy of the floorplan contained here, measurements of doors, windows, rooms and any other items are approximate and no responsibility is taken for any error, omission or mis-statement. This plan is for illustrative purposes only and should be used as such by any prospective purchaser. The services, systems and appliances shown have not been tested and no guarantee as to their operability or efficiency can be given.
Made with Metropix 50023



Lang Town & Country
6 Mannamead Road
Plymouth
PL4 7AA
Tel: 01752 256000
Email: property@langtownandcountry.com
www.langtownandcountry.com

Lang Town & Country endeavour to ensure the accuracy of property details produced and displayed, we have not tested any apparatus, equipment, fixtures, fittings or services and so cannot verify that they are connected, in working order or fit for purpose. A buyer must check the availability of any property and make an appointment to view before embarking on any journey to see a property.

