



3 Hatshill Close, Earls Wood, Plymouth, Devon, PL6 8NN

# Price £650,000



Welcome to this exceptional detached four-bedroom house, situated on a generous plot at the end of a quiet cul-de-sac and built in circa 1976. The property is situated on the edge of the idyllic National Trust Plymbridge Woods which has a wonderful array of wildlife, cycle tracks, woodland walks and history. The property is conveniently located close to supermarkets, park and ride bus service, access to the A38 dual carriageway, Derriford/Nuffield hospitals and the natural beauty of Dartmoor National Park.

This property boasts ample parking with a block-paved driveway and a double garage to the front with a mezzanine level, power and remote-controlled roller door.

Upon entering, you are greeted by a welcoming entrance hall featuring a stunning solid oak wood staircase. The spacious sitting room, with its cosy gas fire, provides a perfect space for relaxation. Adjacent to this is the dining room, complete with a serving hatch. The well-appointed modern kitchen/breakfast room includes a Rangemaster gas cooker, integrated dishwasher and an array of wall and base units, offering ample storage and functionality. A separate utility room adds to the convenience.

The ground floor also includes a fabulous family room/bar, ideal for entertaining and a convenient downstairs cloakroom. The heated conservatory provides a warm and inviting space to enjoy the views of the beautifully landscaped garden regardless of the season.

Upstairs the property features four double bedrooms. The master bedroom benefits from an ensuite shower room and a large balcony, while bedrooms two and three include built-in sliding wardrobes. Bedroom four offers a spacious double cupboard. The family bathroom is a true retreat, complete with a jacuzzi-style air bath with a shower, a corner shower cubicle, a wash hand basin, heated towel rail and WC.

The exterior of the property is just as impressive, with a beautifully landscaped garden featuring a well-manicured lawn, established flower beds, and various patio areas perfect for outdoor entertaining. Additionally, there is a charming summer house with power, providing a versatile space for various uses.

This splendid property combines spacious living areas, modern conveniences, and a beautifully maintained garden, making it a perfect family home.



To view this property call Lang Town & Country Estate Agents on **01752 256000**.

[www.langtownandcountry.com](http://www.langtownandcountry.com)



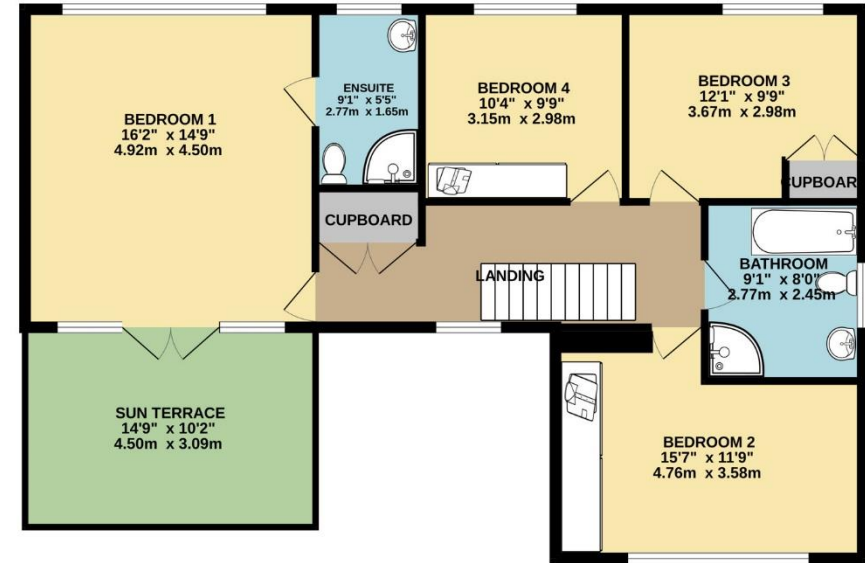

TOTAL FLOOR AREA : 2098 sq.ft. (194.9 sq.m.) approx.

Whilst every attempt has been made to ensure the accuracy of the floorplan contained here, measurements of doors, windows, rooms and any other items are approximate and no responsibility is taken for any error, omission or mis-statement. This plan is for illustrative purposes only and should be used as such by any prospective purchaser. The services, systems and appliances shown have not been tested and no guarantee as to their operability or efficiency can be given.  
Made with Metropix ©2024



Lang Town & Country  
6 Mannamead Road  
Mutley  
Plymouth  
PL4 7AA  
Tel: 01752 256000  
Email: [property@langtownandcountry.com](mailto:property@langtownandcountry.com)

Lang Town & Country endeavour to ensure the accuracy of property details produced and displayed, we have not tested any apparatus, equipment, fixtures, fittings or services and so cannot verify that they are connected, in working order or fit for purpose. A buyer must check the availability of any property and make an appointment to view before embarking on any journey to see a property.

