



Dunlewey Cottage, Glen Road, Mannamead, Plymouth, PL3 5AP

Price £220,000

Lang Town and Country are delighted to offer this unique property, in the heart of the ever-popular Mannamead area of Plymouth. Close to all local amenities such as Mutley Plain and Plymouth's vibrant city centre.

On the ground floor there is a fully fitted, dual aspect, kitchen, comprising a stainless-steel single drainer sink unit with a range of base units and laminate work surfaces, and matching wall cupboards. There is a range of integrated appliances including a oven, hob with an extractor hood, dishwasher, washing machine and fridge freezer. The dual aspect light and airy, living room has a contemporary staircase ascending to the first floor.

On the first floor there are two double bedrooms and a bathroom. The bathroom comprises a panelled bath with shower over, wash hand basin and W.C. The impressive master bedroom has windows and French doors and a balcony with a superb view over Plymouth City Centre and Plymouth Sound beyond.

The property benefits from an allocated parking space.

We would recommend an early viewing to appreciate this unique home, in a prime residential area.



To view this property call Lang Town & Country Estate Agents on **01752 256000**

www.langtownandcountry.com



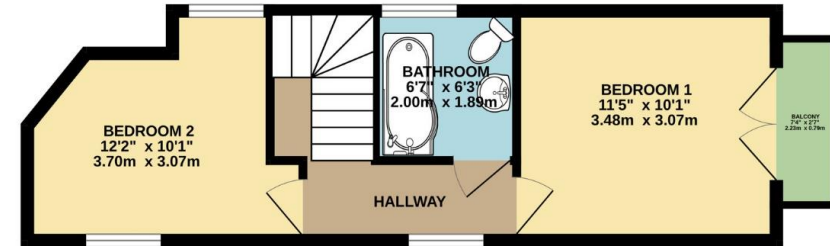
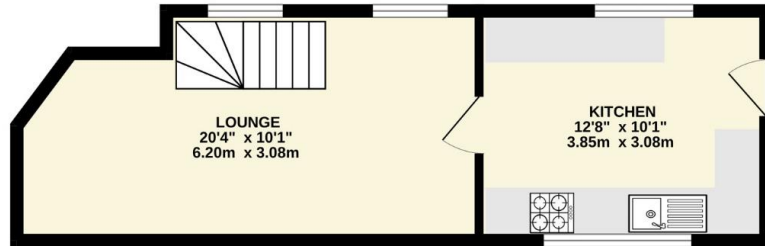

TOTAL FLOOR AREA : 633 sq.ft. (58.8 sq.m.) approx.

Whilst every attempt has been made to ensure the accuracy of the floorplan contained here, measurements of doors, windows, rooms and any other items are approximate and no responsibility is taken for any error, omission or mis-statement. This plan is for illustrative purposes only and should be used as such by any prospective purchaser. The services, systems and appliances shown have not been tested and no guarantee as to their operability or efficiency can be given.
Made with Metropix ©2024



Lang Town & Country
6 Mannamead Road
Plymouth
PL4 7AA
Tel: 01752 256000
Email: property@langtownandcountry.com
www.langtownandcountry.com

Lang Town & Country endeavour to ensure the accuracy of property details produced and displayed, we have not tested any apparatus, equipment, fixtures, fittings or services and so cannot verify that they are connected, in working order or fit for purpose. A buyer must check the availability of any property and make an appointment to view before embarking on any journey to see a property.

