

DEAN COLEMAN



Bespoke Estate Agent

KEY FACTS FOR BUYERS

Pavilion Way, Selly Oak, Birmingham, B29

June 2022

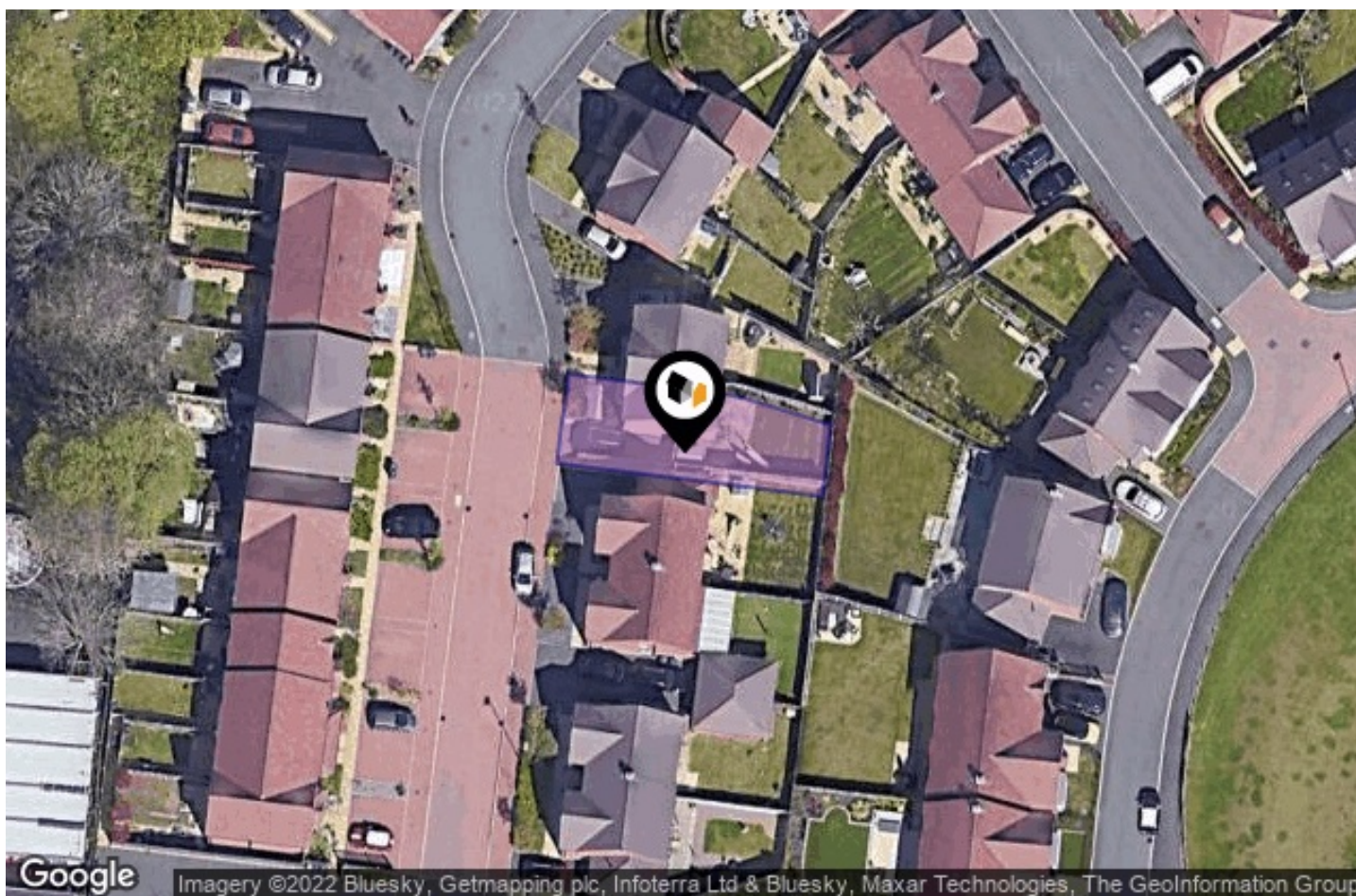

A guide to this property and the local area

Dean Coleman Powered By eXp

Birmingham
07581 875215
dean.coleman@exp.uk.com
<https://exp-uk.co.uk>

Powered by
aprift
Know any property instantly

PROPERTY OVERVIEW

ALL TITLES RELATED TO THIS PROPERTY

Freehold Title Plan

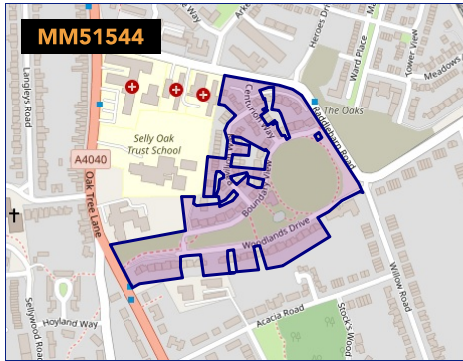

Leasehold Title Plan

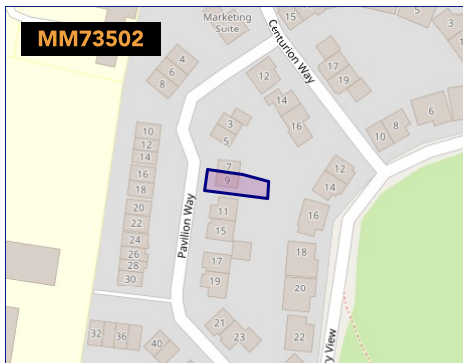

Leasehold Title

Start Date	End Date	Lease Term	Term Remaining
01/01/2015	01/01/3014	999 years	992 years

Dean Coleman Powered By eXp

Birmingham
07581 875215
dean.coleman@exp.uk.com
<https://exp-uk.co.uk>

20th June 2022

DEAN COLEMAN



Bespoke Estate Agent

INTRODUCTION

A superbly presented, new build home still under its NHBC term of 10 years. A superb home for any First Time Buyer, someone looking to downsize or Buy To Let investor who'll benefit from a great location and turn-key home.

Dean Coleman Powered By eXp

Birmingham
07581 875215
dean.coleman@exp.uk.com
<https://exp-uk.co.uk>



PROPERTY OVERVIEW

PAVILION WAY, SELLY OAK, BIRMINGHAM, B29

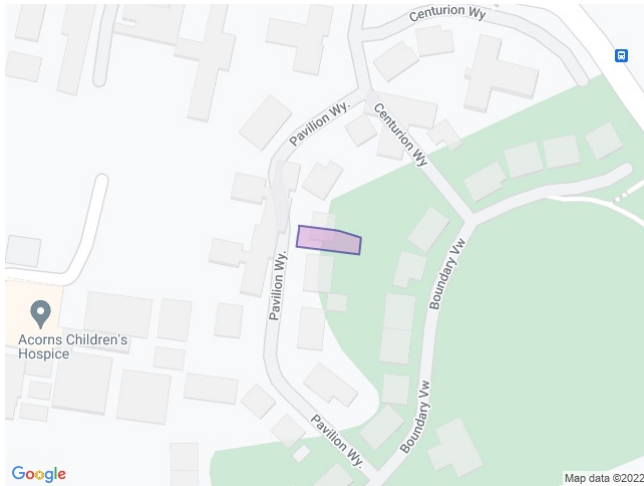

 Boundary (Land Registry Title Plan)



PROPERTY KEY FACTS

Semi-Detached
2 Bedrooms

Floor Area: 688.89 ft²
64.00 m²

Plot Size: 0.04 acres

Council Tax Band: B

Annual Cost: £1,412.09

Land Registry
Title Number: MM73502

Tenure: Leasehold

Lease Start Date: 01 Jan 2015

Lease End Date: 01 Jan 3014

Lease Term: 999 years from 1
January 2015

Term Remaining: 992 years

AREA KEY FACTS

Local Authority: BIRMINGHAM

Flood Risk: Very Low

Conservation Area: No

Predicted Broadband Speeds

Basic: 10 Mbps

Superfast: 55 Mbps

Mobile Coverage
(based on voice calls made indoors)

EE: 

Three: 

O2: 

Vodafone: 

Satellite / Fibre TV Availability

BT: 

Sky: 

Virgin: 

PLANNING HISTORY

No Planning Records Available

Dean Coleman Powered By eXp

Birmingham
07581 875215
dean.coleman@exp.uk.com
<https://exp-uk.co.uk>

Powered by
aprift
Know any property instantly

PROPERTY OVERVIEW

PHOTO GALLERY



Dean Coleman Powered By eXp

Birmingham
07581 875215
dean.coleman@exp.uk.com
<https://exp-uk.co.uk>

Powered by
aprift
Know any property instantly

PROPERTY OVERVIEW

PHOTO GALLERY



Dean Coleman Powered By eXp

Birmingham
07581 875215
dean.coleman@exp.uk.com
<https://exp-uk.co.uk>

Powered by
aprift
Know any property instantly

PROPERTY OVERVIEW

PHOTO GALLERY



Dean Coleman Powered By eXp

Birmingham
07581 875215
dean.coleman@exp.uk.com
<https://exp-uk.co.uk>

Powered by
aprift
Know any property instantly

PROPERTY OVERVIEW

FLOORPLANS

Ground Floor

Approx. 32.4 sq. metres (348.2 sq. feet)

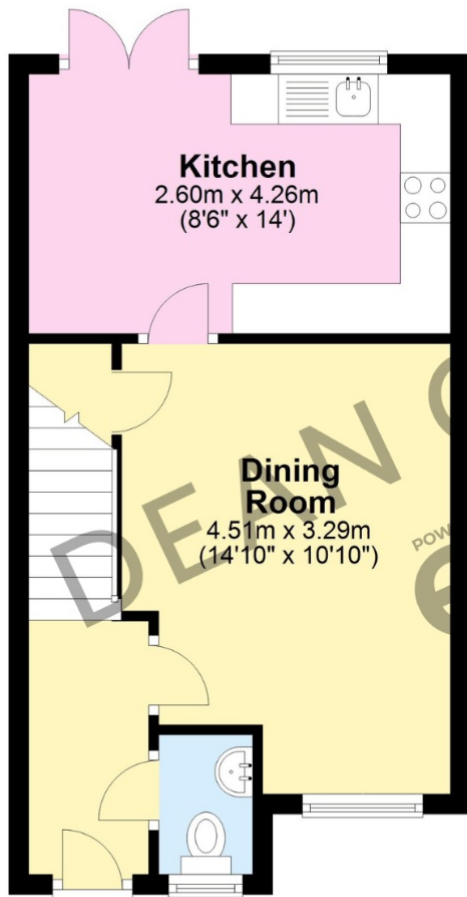

First Floor

Approx. 30.6 sq. metres (329.1 sq. feet)

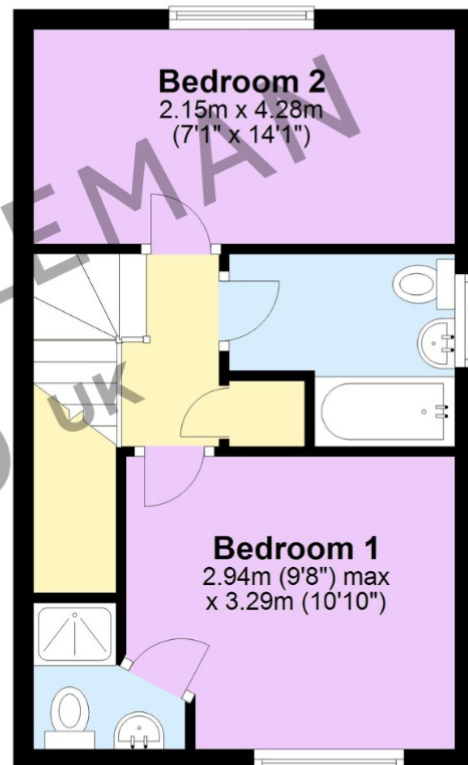

Total area: approx. 62.9 sq. metres (677.3 sq. feet)

Dean Coleman Powered By eXp

Birmingham
07581 875215
dean.coleman@exp.uk.com
<https://exp-uk.co.uk>

Powered by
aprift
Know any property instantly

PROPERTY OVERVIEW

EPC

Pavilion Way, Selly Oak, B29

Energy rating
B

Valid until 13.06.2026

Score	Energy rating	Current	Potential
92+	A		97 A
81-91	B	83 B	
69-80	C		
55-68	D		
39-54	E		
21-38	F		
1-20	G		

Additional EPC Data

No Additional EPC data available

Dean Coleman Powered By eXp

Birmingham
07581 875215
dean.coleman@exp.uk.com
<https://exp-uk.co.uk>

Powered by
aprift
Know any property instantly

DEAN COLEMAN



Bespoke Estate Agent

SOLD ON YOUR STREET

SINCE 1995

34, Pavilion Way, Birmingham, B29 6TX - Terraced House		12, Pavilion Way, Birmingham, B29 6TX - Terraced House	
Dates Sold	Price	Dates Sold	Price
22/06/2021	£175,000	02/12/2019	£240,000
23/09/2016	£159,995		
42, Pavilion Way, Birmingham, B29 6TX - Semi-Detached House		9, Pavilion Way, Birmingham, B29 6TX - Semi-Detached House	
Dates Sold	Price	Dates Sold	Price
23/10/2020	£260,000	29/04/2019	£260,000
05/08/2016	£233,995	29/06/2016	£226,995
28, Pavilion Way, Birmingham, B29 6TX - Terraced House		7, Pavilion Way, Birmingham, B29 6TX - House	
Dates Sold	Price	Dates Sold	Price
29/06/2020	£170,100	23/11/2018	£3,750
20/06/2016	£159,995	29/07/2016	£229,995

Dean Coleman Powered By eXp

Birmingham
 07581 875215
 dean.coleman@exp.uk.com
 https://exp-uk.co.uk

DEAN COLEMAN



Bespoke Estate Agent

SOLD ON YOUR STREET

SINCE 1995

21, Pavilion Way, Birmingham, B29 6TX - House		36, Pavilion Way, Birmingham, B29 6TX - Terraced House	
Dates Sold	Price	Dates Sold	Price
18/01/2018	£340,000	23/09/2016	£159,995
19/08/2016	£329,995		
11, Pavilion Way, Birmingham, B29 6TX - House		32, Pavilion Way, Birmingham, B29 6TX - House	
Dates Sold	Price	Dates Sold	Price
30/11/2016	£324,995	09/09/2016	£219,995
17, Pavilion Way, Birmingham, B29 6TX - House		38, Pavilion Way, Birmingham, B29 6TX - Terraced House	
Dates Sold	Price	Dates Sold	Price
25/11/2016	£324,995	09/09/2016	£227,995

Dean Coleman Powered By eXp

Birmingham
 07581 875215
 dean.coleman@exp.uk.com
 https://exp-uk.co.uk

DEAN COLEMAN



Bespoke Estate Agent

SOLD ON YOUR STREET SINCE 1995

23, Pavilion Way, Birmingham, B29 6TX - Semi-Detached House		15, Pavilion Way, Birmingham, B29 6TX - Semi-Detached House	
Dates Sold	Price	Dates Sold	Price
26/08/2016	£329,995	10/08/2016	£329,995
44, Pavilion Way, Birmingham, B29 6TX - House		46, Pavilion Way, Birmingham, B29 6TX - Semi-Detached House	
Dates Sold	Price	Dates Sold	Price
15/08/2016	£233,995	05/08/2016	£233,995
40, Pavilion Way, Birmingham, B29 6TX - House		19, Pavilion Way, Birmingham, B29 6TX - Semi-Detached House	
Dates Sold	Price	Dates Sold	Price
15/08/2016	£233,995	29/07/2016	£329,995

Dean Coleman Powered By eXp

Birmingham
07581 875215
dean.coleman@exp.uk.com
<https://exp-uk.co.uk>

DEAN COLEMAN



Bespoke Estate Agent

SOLD ON YOUR STREET SINCE 1995

30, Pavilion Way, Birmingham, B29 6TX - House		5, Pavilion Way, Birmingham, B29 6TX - House	
Dates Sold	Price	Dates Sold	Price
30/06/2016	£219,995	08/06/2016	£222,995
24, Pavilion Way, Birmingham, B29 6TX - House		26, Pavilion Way, Birmingham, B29 6TX - House	
Dates Sold	Price	Dates Sold	Price
24/06/2016	£219,995	24/06/2015	£159,995
3, Pavilion Way, Birmingham, B29 6TX - Semi-Detached House			
Dates Sold	Price		
17/06/2016	£229,995		

Dean Coleman Powered By eXp

Birmingham
07581 875215
dean.coleman@exp.uk.com
<https://exp-uk.co.uk>

LOCAL AREA

NEARBY SCHOOLS & RATINGS

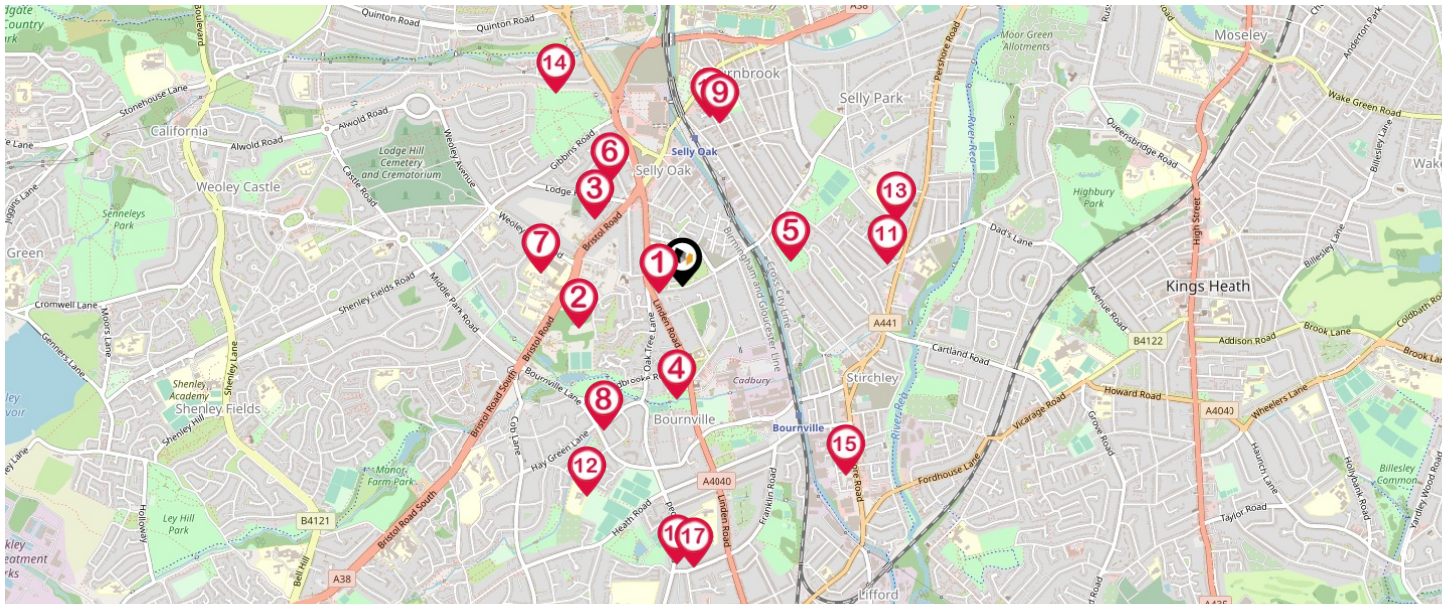

Pin	School Details	Rating	Pupils	Distance	Nursery	Primary	Secondary	College	Private
1	Selly Oak Trust School	Good	376	0.07 Miles	<input type="checkbox"/>	<input type="checkbox"/>	<input checked="" type="checkbox"/>	<input checked="" type="checkbox"/>	<input type="checkbox"/>
2	Fircroft College of Adult Education	Good	-	-	<input type="checkbox"/>	<input type="checkbox"/>	<input type="checkbox"/>	<input checked="" type="checkbox"/>	<input type="checkbox"/>
3	St Mary's Church of England Primary School	Good	418	0.39 Miles	<input type="checkbox"/>	<input checked="" type="checkbox"/>	<input type="checkbox"/>	<input type="checkbox"/>	<input type="checkbox"/>
4	Bournville Village Primary	Outstanding	654	0.4 Miles	<input type="checkbox"/>	<input checked="" type="checkbox"/>	<input type="checkbox"/>	<input type="checkbox"/>	<input type="checkbox"/>
5	Raddlebarn Primary School	Good	429	0.42 Miles	<input checked="" type="checkbox"/>	<input checked="" type="checkbox"/>	<input type="checkbox"/>	<input type="checkbox"/>	<input type="checkbox"/>
6	Cherry Oak School	Requires improvement	111	0.45 Miles	<input checked="" type="checkbox"/>	<input checked="" type="checkbox"/>	<input type="checkbox"/>	<input type="checkbox"/>	<input type="checkbox"/>
7	The University of Birmingham School	Good	1011	0.5 Miles	<input type="checkbox"/>	<input type="checkbox"/>	<input checked="" type="checkbox"/>	<input checked="" type="checkbox"/>	<input type="checkbox"/>
8	Dame Elizabeth Cadbury School	Good	795	0.58 Miles	<input type="checkbox"/>	<input type="checkbox"/>	<input checked="" type="checkbox"/>	<input checked="" type="checkbox"/>	<input type="checkbox"/>
9	Tiverton Academy	Outstanding	218	0.61 Miles	<input checked="" type="checkbox"/>	<input checked="" type="checkbox"/>	<input type="checkbox"/>	<input type="checkbox"/>	<input type="checkbox"/>
10	Selly Oak Nursery School	Outstanding	76	0.63 Miles	<input checked="" type="checkbox"/>	<input checked="" type="checkbox"/>	<input type="checkbox"/>	<input type="checkbox"/>	<input type="checkbox"/>
11	Selly Park Girls' School	Outstanding	703	0.76 Miles	<input type="checkbox"/>	<input type="checkbox"/>	<input checked="" type="checkbox"/>	<input type="checkbox"/>	<input type="checkbox"/>
12	St Francis Church of England Aided Primary School and Nu...	Good	234	0.82 Miles	<input checked="" type="checkbox"/>	<input checked="" type="checkbox"/>	<input type="checkbox"/>	<input type="checkbox"/>	<input type="checkbox"/>
13	St Edward's Catholic Primary School	Good	401	0.82 Miles	<input type="checkbox"/>	<input checked="" type="checkbox"/>	<input type="checkbox"/>	<input type="checkbox"/>	<input type="checkbox"/>
14	Water Mill Primary School	Requires improvement	199	0.83 Miles	<input type="checkbox"/>	<input checked="" type="checkbox"/>	<input type="checkbox"/>	<input type="checkbox"/>	<input type="checkbox"/>
15	Stirchley Primary School	Good	226	0.91 Miles	<input checked="" type="checkbox"/>	<input checked="" type="checkbox"/>	<input type="checkbox"/>	<input type="checkbox"/>	<input type="checkbox"/>
16	St Joseph's Catholic Primary School	Good	211	1 Miles	<input type="checkbox"/>	<input checked="" type="checkbox"/>	<input type="checkbox"/>	<input type="checkbox"/>	<input type="checkbox"/>
17	Kings Norton Girls' School	Outstanding	1013	1.01 Miles	<input type="checkbox"/>	<input type="checkbox"/>	<input checked="" type="checkbox"/>	<input checked="" type="checkbox"/>	<input type="checkbox"/>

Dean Coleman Powered By eXP

Birmingham
 07581 875215
 dean.coleman@exp.uk.com
<https://exp-uk.co.uk>

Powered by

 Know any property instantly

LOCAL AREA

NEAREST TRANSPORT LINKS

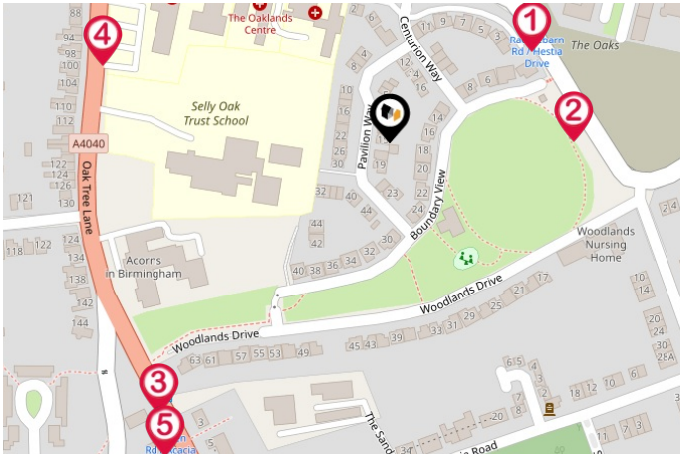

BUS STOPS/STATIONS

- 1 - Hestia Drive | 0.08 miles
- 2 - Hestia Drive | 0.09 miles
- 3 - Acacia Rd | 0.16 miles
- 4 - Raddlebarn Rd | 0.13 miles
- 5 - Acacia Rd | 0.17 miles

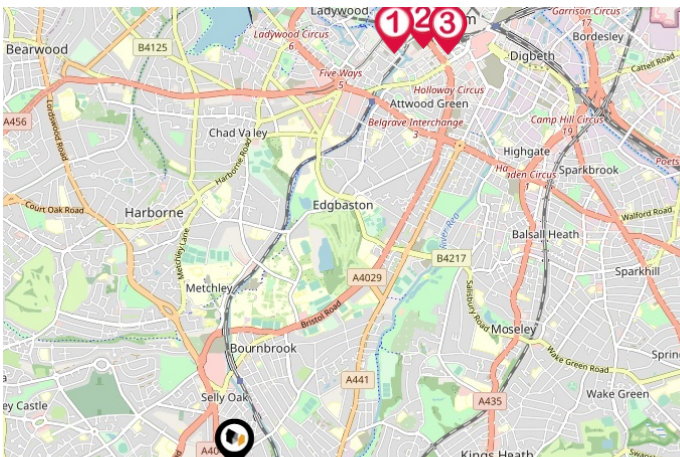

LOCAL CONNECTIONS

- 1 - Centenary Square (Midlands Metro Stop) | 3.22 miles
- 2 - Town Hall (Midlands Metro Stop) | 3.34 miles
- 3 - Grand Central New Street (Midland Metro Stop) | 3.38 miles

Dean Coleman Powered By eXp

Birmingham
07581 875215
dean.coleman@exp.uk.com
<https://exp-uk.co.uk>

Powered by
aprift
Know any property instantly

LOCAL AREA

NEAREST TRANSPORT LINKS

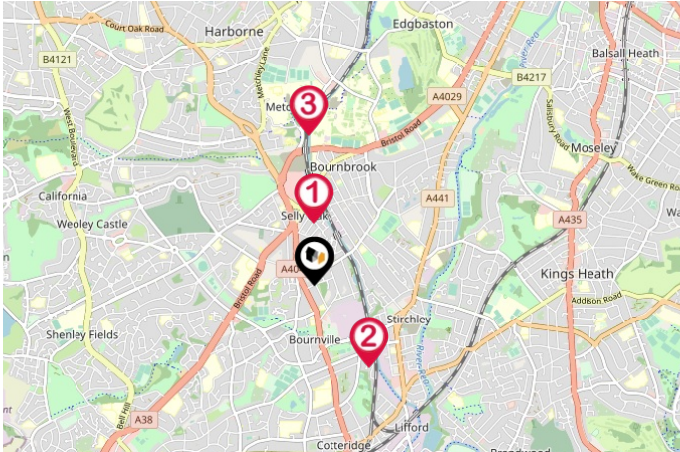

NATIONAL RAIL STATIONS

- 1 - Selly Oak Rail Station | 0.46 miles
- 2 - Bournville Rail Station | 0.72 miles
- 3 - University Rail Station | 1.1 miles

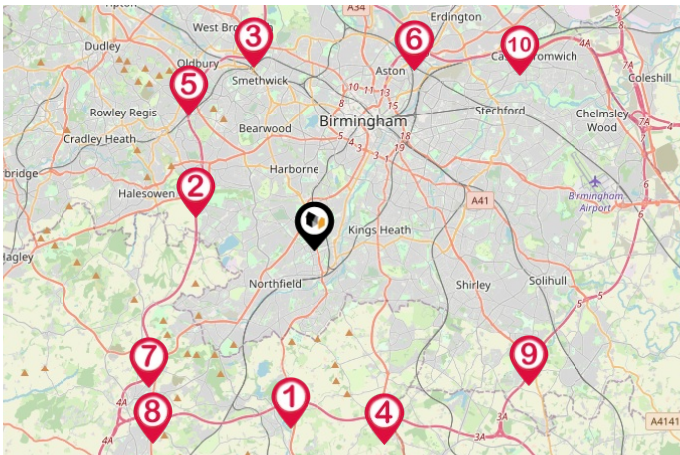

TRUNK ROADS/MOTORWAYS

- 1 - M42 J2 | 5.12 miles
- 2 - M5 J3 | 3.43 miles
- 3 - M5 J1 | 5.57 miles
- 4 - M42 J3 | 5.97 miles
- 5 - M5 J2 | 5.26 miles
- 6 - M6 J6 | 6.05 miles
- 7 - M5 J4 | 6.08 miles
- 8 - M42 J1 | 7.15 miles
- 9 - M42 J4 | 7.41 miles
- 10 - M6 J5 | 7.92 miles

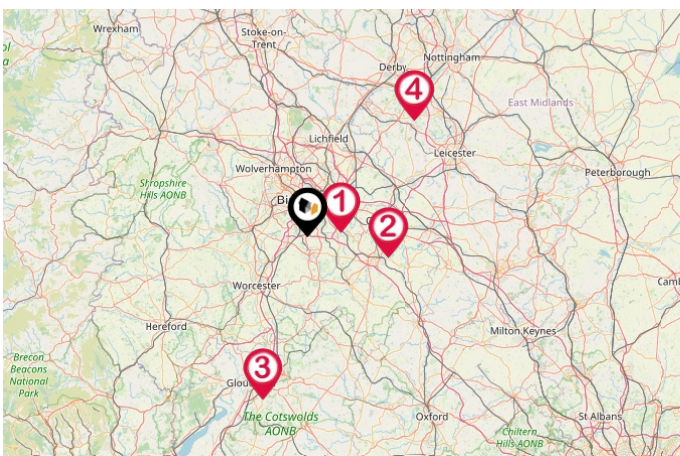

AIRPORTS/HELIPADS

- 1 - Birmingham International Airport | 8.74 miles
- 2 - Coventry Airport | 20.04 miles
- 3 - Gloucestershire Airport | 38.68 miles
- 4 - East Midlands Airport | 37.18 miles

Dean Coleman Powered By eXp

Birmingham
 07581 875215
 dean.coleman@exp.uk.com
 https://exp-uk.co.uk

Powered by
aprift
 Know any property instantly

LOCAL MARKET

HOUSE PRICE STATISTICS FOR B29

10 YEAR HISTORY OF AVERAGE PRICES BY PROPERTY TYPE

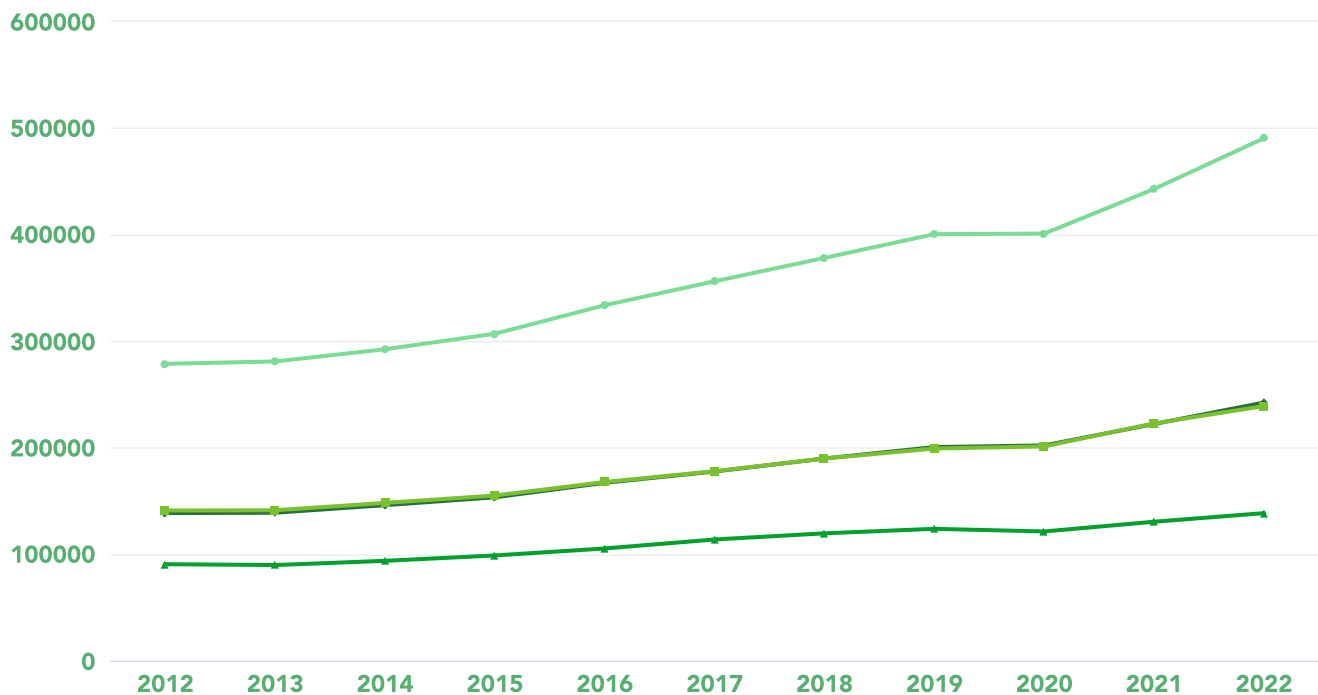

FLAT
+ 52.83%



TERRACED
+ 69.45%



SEMI-DETACHED
+ 74.81%



DETACHED
+ 75.94%

£280,000
Asking Price

Dean Coleman Powered By eXp

Birmingham
07581 875215
dean.coleman@exp.uk.com
<https://exp-uk.co.uk>

Powered by
aprift
Know any property instantly

DEAN COLEMAN POWERED BY EXP

About Us

Through our Estate Agent Productivity Suite and Rightmove and Zoopla subscriptions, buyers have access to all the latest listings including those from eXp UK network of estate agents. Buyers can search on the most relevant, local criteria that means the most to them including neighbourhoods, schools, parks, house size, rooms and price, all the details that are involved in selecting the home where you'll love to live.

Dean Coleman Powered By eXp

Birmingham
07581 875215
dean.coleman@exp.uk.com
<https://exp-uk.co.uk>



TESTIMONIALS

WHAT OUR CLIENTS THINK

Testimonial 1



We had a first class experience from start to finish. Our agent was professional, knowledgeable, experienced and a very friendly person. Im sure his nature and professionalism attributed to selling our house in under a week. After the first viewings our hose was sold, for asking price. The whole timescale to sell took around 12 weeks and Dean was amazing. I had his number and could message about anything, no matter how trivial.

Testimonial 2



I would highly recommend Dean, Very good at booking viewings and working around what suited me. Dean certainly knew his stuff! He made the whole process so much easier and explained everything clearly along the way. He always answered the phone and we never felt like he was too busy or uninterested even though he had loads of other properties to deal with. He had a wealth of experience and always kept us up to date with what was going on.

Testimonial 3



We have just sold our property and I couldn't be happier with the process. Dean has been fantastic throughout the process, he really went the extra mile in terms of helping out with various enquiries to organising the key handover, he really made a difference during the sale and gave the process a personal touch. Would highly recommend Dean!

Dean Coleman Powered By eXp

Birmingham
07581 875215
dean.coleman@exp.uk.com
<https://exp-uk.co.uk>

DATA QUALITY

Dean Coleman Powered By eXp is committed to comprehensive property data being made available upfront to make the home buying and selling process quicker, easier and cheaper. Which is why they have partnered with Sprift, the UK's leading supplier of property specific data.

Data Partners:



Contains public sector information licensed under the Open Government Licence v3.0

The information contained in this report is for general information purposes only and to act as a guide to the best way to market your property and the asking price.

Sprift Technologies Limited aggregate this data from a wide variety of sources and while we endeavour to keep the information up to date and correct, we make no representations or warranties of any kind, express or implied, about the completeness, accuracy, reliability, of the information or related graphics contained in this report for any purpose. Any reliance you place on such information is therefore strictly at your own risk. In no event will we be liable for any loss or damage including without limitation, indirect or consequential loss or damage, or any loss or damage whatsoever arising from loss of data or profits arising out of, or in connection with, the use of this report.

Information produced by HM Land Registry. Crown copyright and database rights 2022