



Smiths
your property experts

Ruby Street

Leicester

- Available now
- Self-contained one-bedroom property
- Well-presented living accommodation
- Shared courtyard garden
- Private entrance door
- Open-plan kitchen and living area
- Easy reach of Leicester city centre and Fosse Park
- Unfurnished

General Description

Smiths Property Experts offer this well-presented, self-contained one-bedroom property to the rental market. The property is conveniently located and within easy reach of Leicester city centre, Fosse Park and the M1/M69 motorway link.

The Property

The property is available to let on a long-term basis and is in excellent condition internally. Accessed via a gated entry, it benefits from a shared courtyard garden. The property has its own private entrance door leading to an open-plan kitchen and living area. The kitchen is complete with all appliances. Upstairs, you will find a double bedroom with an en-suite shower room.





Letting Information

Long Term.

Unfurnished.

Available now.

Property Information

EPC Rating: D.

Council Tax Band: A.

Local Authority: Leicester City Council.

Important Information

Every care has been taken with the preparation of these particulars, but complete accuracy cannot be guaranteed. All measurements should be treated as approximate and for general guidance only.



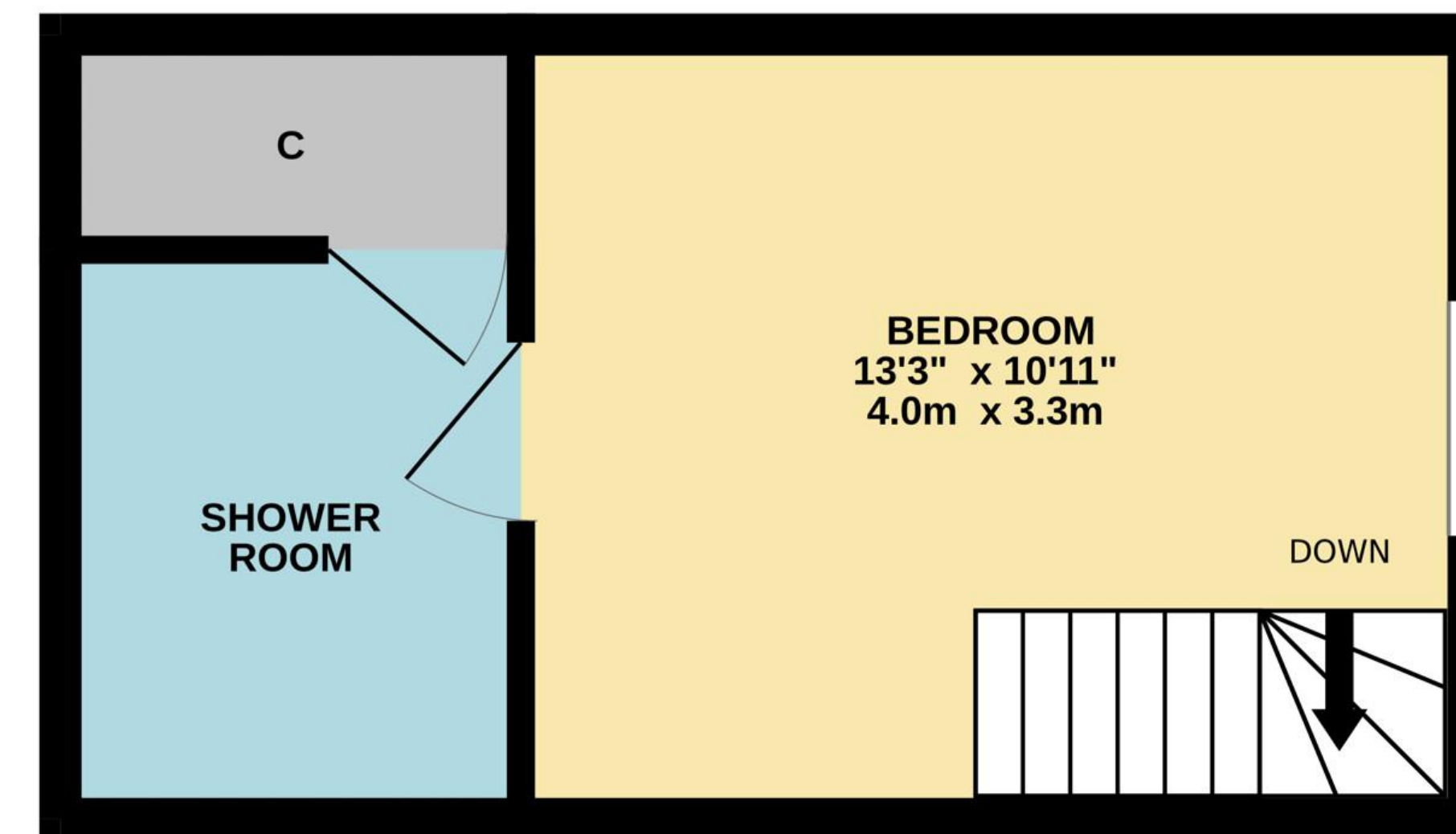
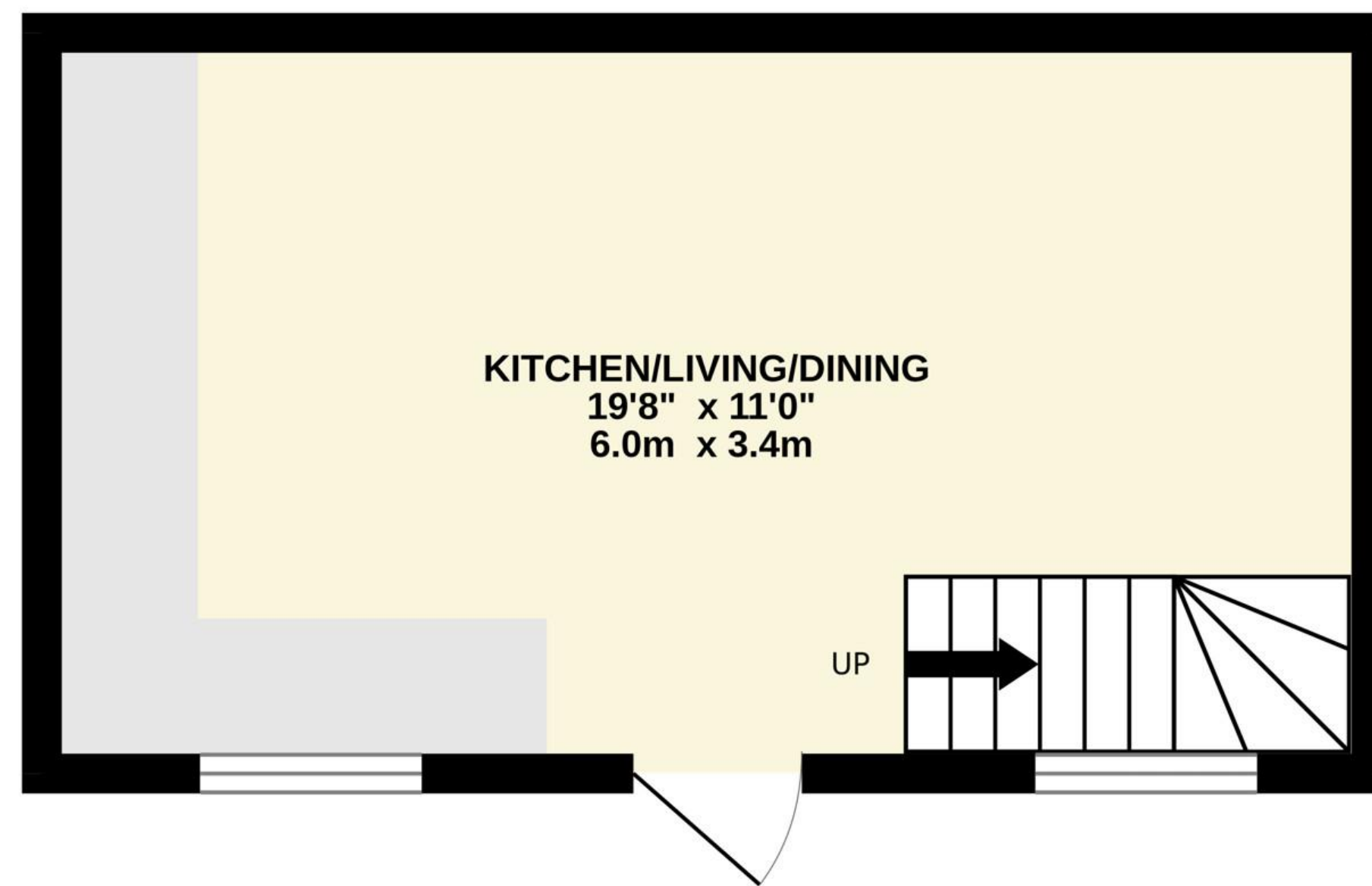

TOTAL FLOOR AREA : 432 sq.ft. (40.2 sq.m.) approx.

Whilst every attempt has been made to ensure the accuracy of the floorplan contained here, measurements of doors, windows, rooms and any other items are approximate and no responsibility is taken for any error, omission or mis-statement. This plan is for illustrative purposes only and should be used as such by any prospective purchaser. The services, systems and appliances shown have not been tested and no guarantee as to their operability or efficiency can be given.
Made with Metropix ©2024



01509 278842

sales@smithspropertyexperts.com

smithspropertyexperts.com

