

Underlane, Plympton, Plymouth, PL7 1QY

Offers Over £350,000

4 2 3



- Character 3/4 bedroom semi detached house
- Master bedroom with Juliet balcony
- Open plan kitchen, family room and dining room
- Far reaching views to the Moors
- Generous South-facing garden
- Deceptively spacious and versatile living accommodation
- 2 bathrooms
- Separate lounge with multifuel fire
- Driveway parking
- Close to Primary and Secondary Schools

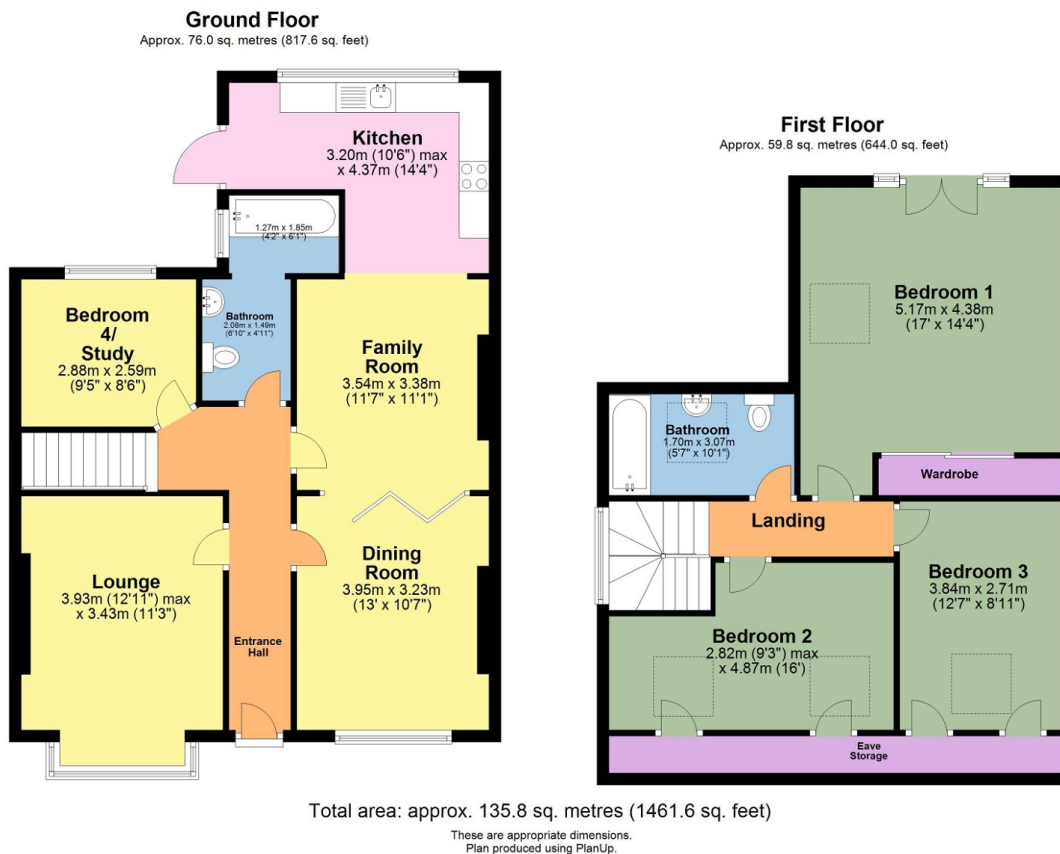

A deceptively spacious 3/4 bedroom semi-detached character property which is situated on a private road in Plympton. The property offers a generous amount of ground floor living space with the potential for multi-generational living due to the 4th bedroom/Study and a bathroom on the ground floor. The property has been extended and renovated by the current vendors to create spacious living accommodation whilst still retaining the original character and charm of the property.