



Lions Close, London, SE9

Rent: £1,400pcm

COCKBURN
ESTATE AND LETTINGS AGENTS



Lions Close, London, SE9

Cockburn are pleased to present this lovely one-bedroom garden flat, located at Lions Close. This property is available for rent and offers a comfortable and peaceful living space for those looking for a new home. The flat is in great condition and has been well-maintained throughout. Comprising of a spacious and bright living room, a modern and fully-equipped kitchen, cozy bedroom, and stylish bathroom. With ample storage space throughout, and the standout feature of your own private garden - the well-maintained outdoor space is perfect for enjoying a morning cup of coffee or a relaxing evening meal. With allocated parking (permit to be provided), green spaces within walking distance and excellent transport links nearby, this wonderful flat is sure to be snapped up quick - call now to avoid disappointment!

KEY FEATURES:

Available Now

One Bedroom

Unfurnished

Finished To A High Standard Throughout

Private Garden Space

Walking Distance To Green Spaces

Excellent Transport Links Nearby

Close To Local Amenities Including Shops

Energy Rating C

Council Tax Band B – Lewisham London Borough Council

Score	Energy rating	Current	Potential
92+	A		
81-91	B		
69-80	C	78 C	78 C
55-68	D		
39-54	E		
21-38	F		
1-20	G		





Lions Close, London, SE9

Approximate Area = 531 sq ft / 49.3 sq m

For identification only - Not to scale

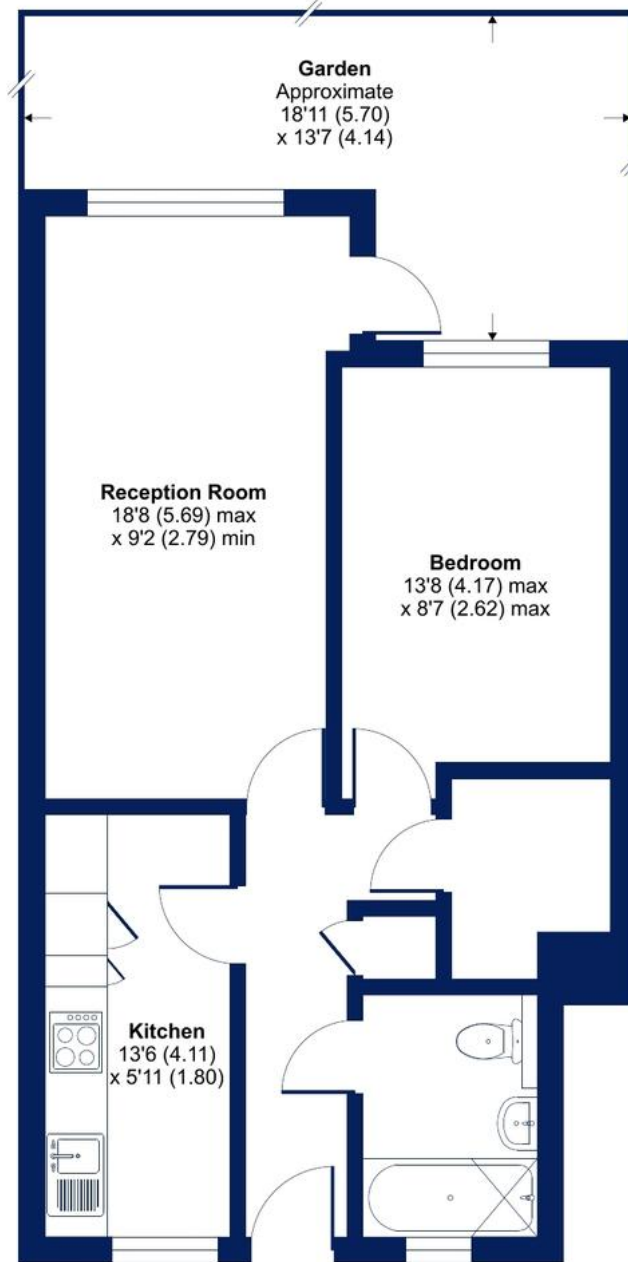

GROUND FLOOR



Floor plan produced in accordance with RICS Property Measurement Standards incorporating International Property Measurement Standards (IPMS2 Residential). © nchecon 2023. Produced for Cockburn Estates Agents. REF: 977028

Cockburn EA
38 Mottingham Road, Mottingham, London, SE9 4QR
t: 020 8857 8857

cockburn-online.co.uk

COCKBURN
ESTATE AND LETTINGS AGENTS

IMPORTANT: we would like to inform prospective purchasers that these sales particulars have been prepared as a general guide only. A detailed survey has not been carried out, nor the services, appliances and fittings tested. Room sizes should not be relied upon for furnishing purposes and are approximate. If floor plans are included, they are for guidance only and illustration purposes only and may not be to scale. If there are any important matters likely to affect your decision to buy, please contact us before viewing the property.