



Greenacres, Eltham, SE9

Offers Over £425,000

🛏️ 2 🚿 1 🚗 1



- Chain Free Sale
- Quiet Development
- Extensive Parking With Garage Also
- Within Easy Reach Of Eltham Railway Station
- Council Tax Band C - Royal Borough Of Greenwich
- Share Of Freehold
- Large Through Reception/ Dining Area
- Close To Eltham High Street Shops, Eateries, Cinema & Leisure Facilities
- Excellent Bus Links Keeping You Connected With Bromley, Greenwich & Sidcup



*** CHAIN FREE ***

Cockburn present to the market this wonderful opportunity to own a spacious and inviting two-bedroom apartment in the highly sought-after development of Greenacres, Eltham.

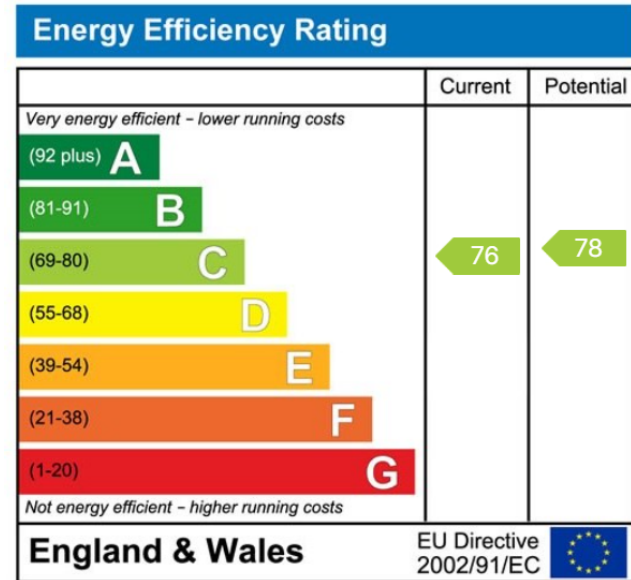
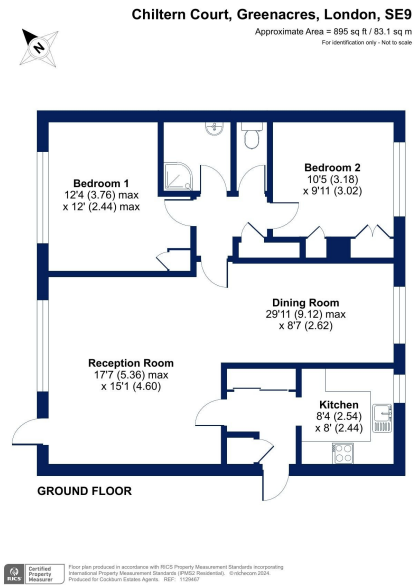

Cockburn EA

352 Footscray Road,
London, SE9 2EB

t: 020 8859 8590