

31 The Glebe

£215,000

🛏 2 🚿 1 🚻 1



A well positioned, two bedroom mid-terrace home offering a perfect opportunity for first time buyers or investors to buy a sensibly priced house in the extremely popular village of Wroughton



Key Features

- No onward chain
- Perfect investment or first time buy opportunity
- West facing garden to the rear
- Two bedrooms and first floor bathroom
- Wonderfully positioned two bedroom terraced home
- Off street parking
- Bay fronted sitting/dining room
- In need of moderate updating

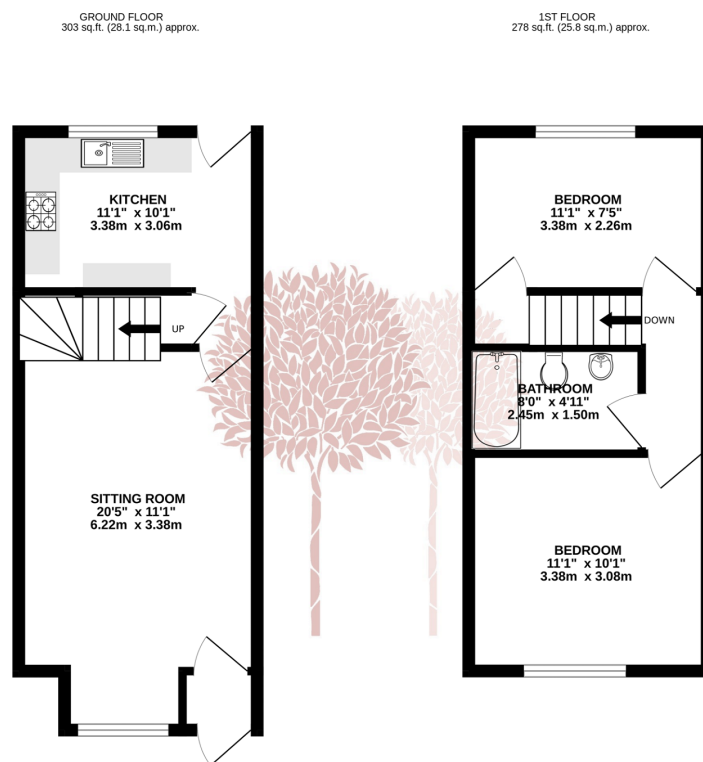

TOTAL FLOOR AREA: 581 sq.ft. (53.9 sq.m.) approx.

Whilst every attempt has been made to ensure the accuracy of the floorplan contained herein, measurements of doors, windows, rooms and any other items are approximate and no responsibility is taken for any error, omission or misstatement. This plan is for illustrative purposes only and should be used as such by any prospective purchaser. The services, systems and appliances shown have not been tested and no guarantee as to their operability or efficiency can be given.

Made with Metropix ©2024

