

School Road, Wroughton

£105,000

🛏 2 🚿 1 🚗 1



A SUPER two-bedroom first floor apartment with excellent natural light that is set towards the front of the building with an open aspect. Offered to the market with no onward chain



Key Features

- Light and airy first floor apartment
- Designated over 55's development
- Generous sitting room with kitchen off
- Allocated off-street parking
- Council Tax band C
- Superb convenient village position
- Two bedrooms (both with fitted cupboards)
- Resident's reception lounge, laundry and guest suite
- No onward chain
- EPC rating C

GROUND FLOOR
581 sq.ft. (54.0 sq.m.) approx.

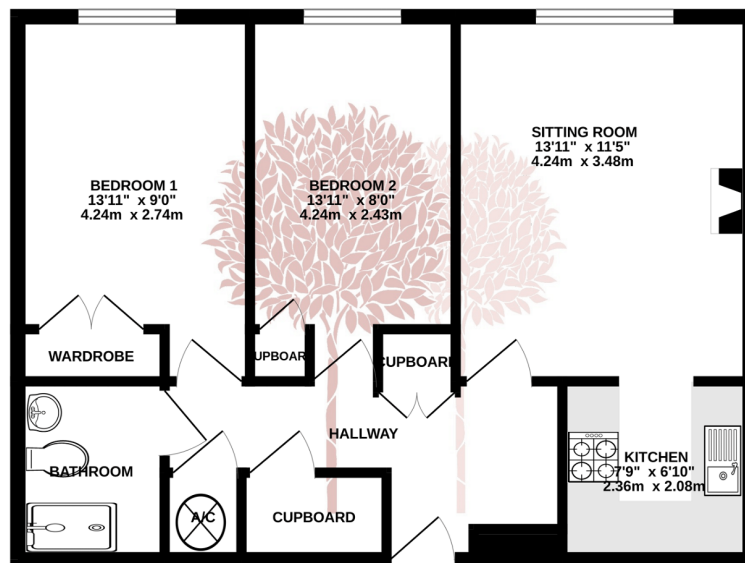

TOTAL FLOOR AREA - 581 sq. ft. (54.0 sq.m.) approx.

Whilst every attempt has been made to ensure the accuracy of the floorplan contained here, measurements of doors, windows, rooms and any other items are approximate and no responsibility is taken for any error, omission or misstatement. This plan is for illustrative purposes only and should be used as such by any prospective purchaser. The services, systems and appliances shown have not been tested and no guarantee as to their operability or efficiency can be given.

Made with Metropix ©2023

