

Ridge Crescent, West Harptree

Guide Price £350,000

3 1 2



MODERNISATION REQUIRED - A much-loved home in the popular village of West Harptree, occupying a good sized plot with attractive gardens and huge scope to extend EPC E



Key Features

- Three bedroom semi-detached house
- Side access
- Two reception rooms
- Mature gardens
- Council Tax Band C
- Scope to extend (subject to planning permission)
- Large south facing garden
- Downstairs WC
- Village location
- EPC E

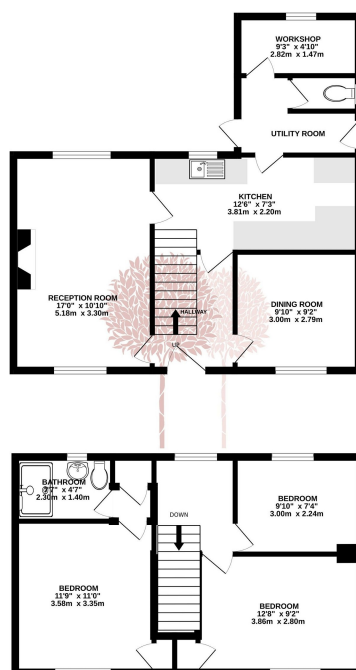

TOTAL FLOOR AREA: 957 sq.ft. (88.9 sq.m.) approx.

Whilst every attempt has been made to ensure the accuracy of the floorplan contained herein, measurements of doors, windows, rooms and any other items are approximate and no responsibility is taken for any error, omission or mis-statement. This plan is for illustrative purposes only and should be used as such by any prospective purchaser. The services, systems and appliances shown have not been tested and no guarantee as to their operability or efficiency can be given.
Made with Metronix i2024

