



See More Online

KFB: Key Facts For Buyers

A Guide to This Property & the Local Area

Monday 28th October 2024



VICTORIA ROAD, DISS, IP22

Whittley Parish | Diss

4-6 Market Hill Diss IP22 4JZ

01379640808

admin@whittleyparish.com

<https://www.whittleyparish.com/>



Property Overview

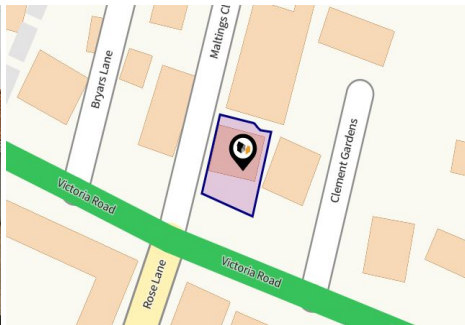

Property

Type:	Detached	Tenure:	Freehold
Bedrooms:	3		
Floor Area:	1,259 ft ² / 117 m ²		
Plot Area:	0.07 acres		
Year Built :	1983-1990		
Council Tax :	Band C		
Annual Estimate:	£2,007		
Title Number:	NK208019		

Local Area

Local Authority:	Norfolk
Conservation Area:	No
Flood Risk:	
• Rivers & Seas	No Risk
• Surface Water	Very Low

Estimated Broadband Speeds (Standard - Superfast - Ultrafast)

12 mb/s	80 mb/s	10000 mb/s

Mobile Coverage: (based on calls indoors)



Satellite/Fibre TV Availability:



Planning History

This Address



Planning records for: *Victoria Road, Diss, IP22*

Reference - 2004/0303	
Decision:	Decided
Date:	16th February 2004
Description:	Extension to dwelling









VICTORIA ROAD, DISS, IP22

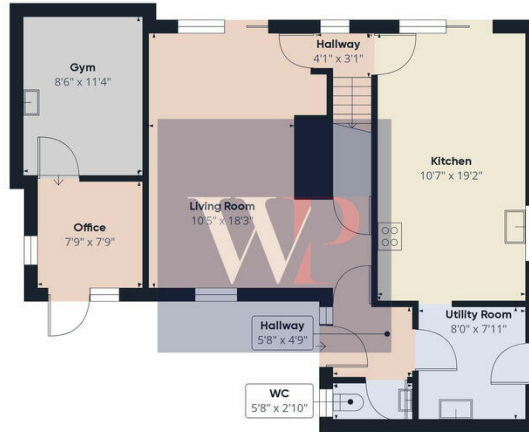

Floor 0

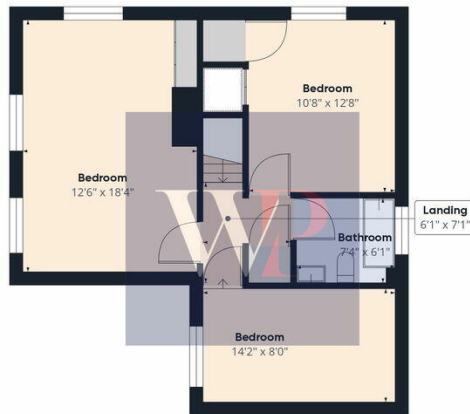

Floor 1



Approximate total area[®]
1326.54 ft²

(1) Excluding balconies and terraces

While every attempt has been made to ensure accuracy, all measurements are approximate, not to scale. This floor plan is for illustrative purposes only.

Calculations were based on RICS IPMS 3C standard. Please note that calculations were adjusted by a third party and therefore may not comply with RICS IPMS 3C.

GIRAFFE 360



DISS, IP22

Energy rating

C

Valid until 25.10.2034

Score	Energy rating	Current	Potential
92+	A		
81-91	B		
69-80	C	69 c	80 c
55-68	D		
39-54	E		
21-38	F		
1-20	G		

Property

EPC - Additional Data



Additional EPC Data

Property Type:	Detached house
Walls:	Cavity wall, as built, insulated (assumed)
Walls Energy:	Good
Roof:	Pitched, 150 mm loft insulation
Roof Energy:	Good
Window:	Fully double glazed
Window Energy:	Average
Main Heating:	Boiler and radiators, mains gas
Main Heating Energy:	Good
Main Heating Controls:	Programmer, room thermostat and TRVs
Main Heating Controls Energy:	Good
Hot Water System:	From main system
Hot Water Energy Efficiency:	Good
Lighting:	Low energy lighting in 88% of fixed outlets
Lighting Energy:	Very good
Floors:	Suspended, no insulation (assumed)
Secondary Heating:	Room heaters, mains gas
Total Floor Area:	116 m ²

Area Schools

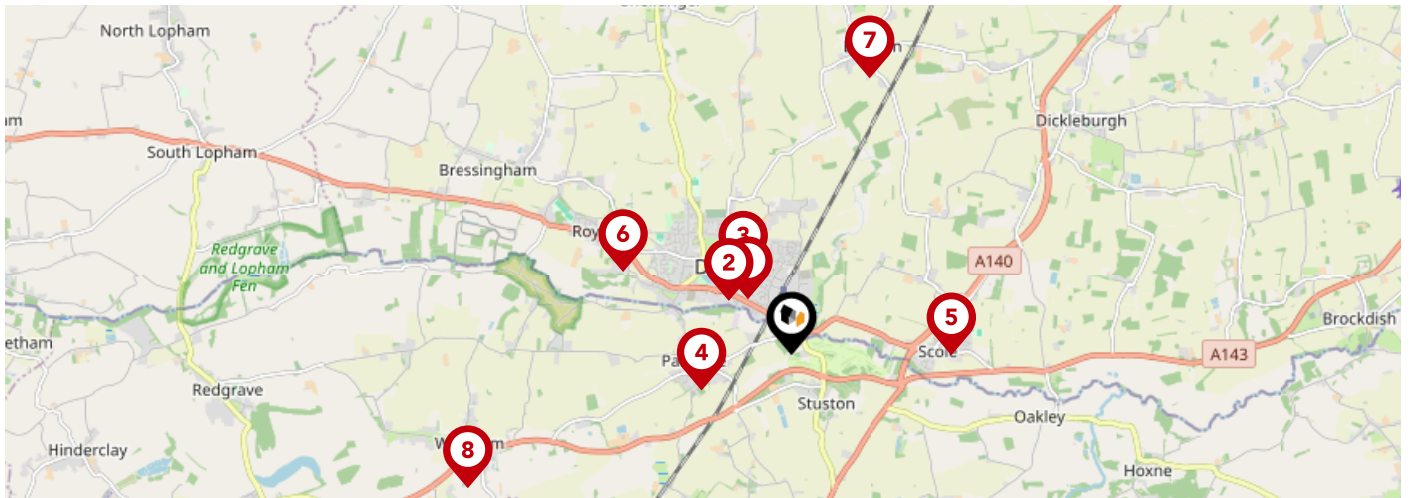

	Nursery	Primary	Secondary	College	Private
<p>1 Diss Infant Academy and Nursery Ofsted Rating: Requires improvement Pupils: 116 Distance:0.65</p>	<input type="checkbox"/>	<input checked="" type="checkbox"/>	<input type="checkbox"/>	<input type="checkbox"/>	<input type="checkbox"/>
<p>2 Diss Church of England Junior Academy Ofsted Rating: Good Pupils: 189 Distance:0.75</p>	<input type="checkbox"/>	<input checked="" type="checkbox"/>	<input type="checkbox"/>	<input type="checkbox"/>	<input type="checkbox"/>
<p>3 Diss High School Ofsted Rating: Good Pupils: 941 Distance:0.85</p>	<input type="checkbox"/>	<input type="checkbox"/>	<input checked="" type="checkbox"/>	<input type="checkbox"/>	<input type="checkbox"/>
<p>4 Palgrave Church of England Primary School Ofsted Rating: Good Pupils: 82 Distance:0.88</p>	<input type="checkbox"/>	<input checked="" type="checkbox"/>	<input type="checkbox"/>	<input type="checkbox"/>	<input type="checkbox"/>
<p>5 Scole Church of England Primary Academy Ofsted Rating: Good Pupils: 51 Distance:1.45</p>	<input type="checkbox"/>	<input checked="" type="checkbox"/>	<input type="checkbox"/>	<input type="checkbox"/>	<input type="checkbox"/>
<p>6 Roydon Primary School Ofsted Rating: Good Pupils: 261 Distance:1.7</p>	<input type="checkbox"/>	<input checked="" type="checkbox"/>	<input type="checkbox"/>	<input type="checkbox"/>	<input type="checkbox"/>
<p>7 Burston Community Primary School Ofsted Rating: Good Pupils: 36 Distance:2.61</p>	<input type="checkbox"/>	<input checked="" type="checkbox"/>	<input type="checkbox"/>	<input type="checkbox"/>	<input type="checkbox"/>
<p>8 Wortham Primary School Ofsted Rating: Outstanding Pupils: 102 Distance:3.17</p>	<input type="checkbox"/>	<input checked="" type="checkbox"/>	<input type="checkbox"/>	<input type="checkbox"/>	<input type="checkbox"/>

Area Schools



		Nursery	Primary	Secondary	College	Private
	Dickleburgh Church of England Primary Academy (With Pre-School) Ofsted Rating: Outstanding Pupils: 187 Distance:3.18	<input type="checkbox"/>	<input checked="" type="checkbox"/>	<input type="checkbox"/>	<input type="checkbox"/>	<input type="checkbox"/>
	Hartismere School Ofsted Rating: Outstanding Pupils: 1063 Distance:3.21	<input type="checkbox"/>	<input type="checkbox"/>	<input checked="" type="checkbox"/>	<input type="checkbox"/>	<input type="checkbox"/>
	Mellis Church of England Primary School Ofsted Rating: Good Pupils: 154 Distance:3.28	<input type="checkbox"/>	<input checked="" type="checkbox"/>	<input type="checkbox"/>	<input type="checkbox"/>	<input type="checkbox"/>
	Bressingham Primary School Ofsted Rating: Good Pupils: 142 Distance:3.37	<input type="checkbox"/>	<input checked="" type="checkbox"/>	<input type="checkbox"/>	<input type="checkbox"/>	<input type="checkbox"/>
	St Peter and St Paul Church of England Primary School, Eye Ofsted Rating: Good Pupils: 181 Distance:3.5	<input type="checkbox"/>	<input checked="" type="checkbox"/>	<input type="checkbox"/>	<input type="checkbox"/>	<input type="checkbox"/>
	All Saints Church of England Voluntary Aided Primary School, Winfarthing Ofsted Rating: Good Pupils: 27 Distance:4.04	<input type="checkbox"/>	<input checked="" type="checkbox"/>	<input type="checkbox"/>	<input type="checkbox"/>	<input type="checkbox"/>
	St Edmund's Primary School Ofsted Rating: Good Pupils: 67 Distance:4.16	<input type="checkbox"/>	<input checked="" type="checkbox"/>	<input type="checkbox"/>	<input type="checkbox"/>	<input type="checkbox"/>
	Tivetshall Community Primary School Ofsted Rating: Good Pupils: 28 Distance:5.21	<input type="checkbox"/>	<input checked="" type="checkbox"/>	<input type="checkbox"/>	<input type="checkbox"/>	<input type="checkbox"/>

Area

Transport (National)

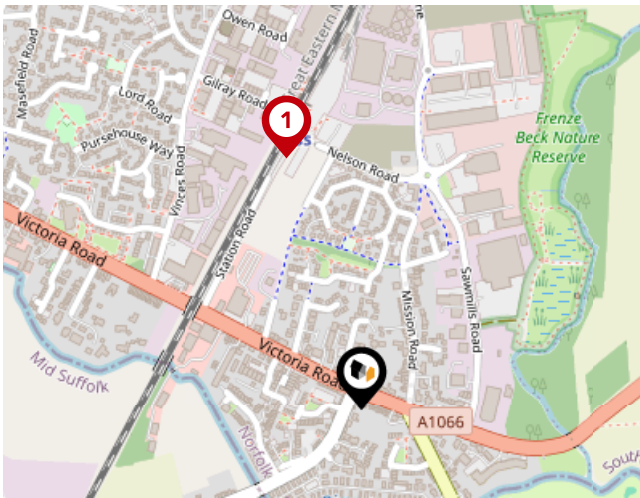

National Rail Stations

Pin	Name	Distance
1	Diss Rail Station	0.3 miles
2	Attleborough Rail Station	10.95 miles
3	Eccles Road Rail Station	9.63 miles

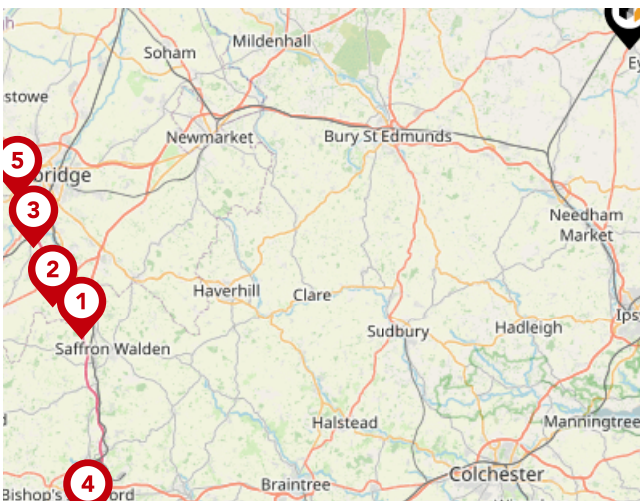

Trunk Roads/Motorways

Pin	Name	Distance
1	M11 J9	45.06 miles
2	M11 J10	45.83 miles
3	M11 J11	45.62 miles
4	M11 J8	52.32 miles
5	M11 J13	45.63 miles

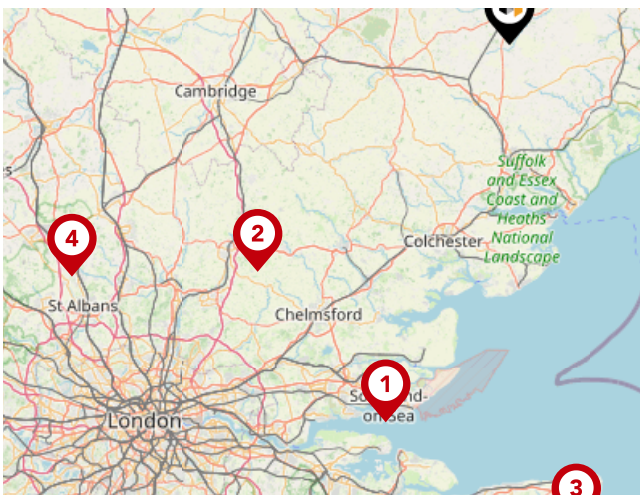

Airports/Helipads

Pin	Name	Distance
1	Southend-on-Sea	58.2 miles
2	Stansted Airport	49.44 miles
3	Manston	71.42 miles
4	Luton Airport	72.19 miles

Area

Transport (Local)

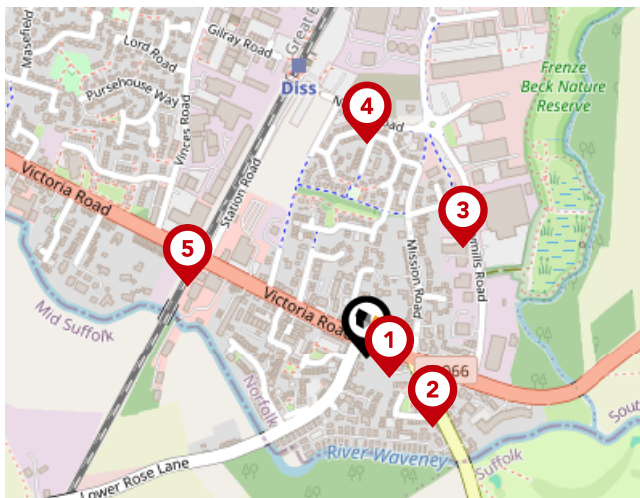

Bus Stops/Stations

Pin	Name	Distance
1	Rose Lane	0.03 miles
2	White Elephant	0.11 miles
3	Mission Court	0.17 miles
4	Ensign Way	0.24 miles
5	Station Road	0.22 miles

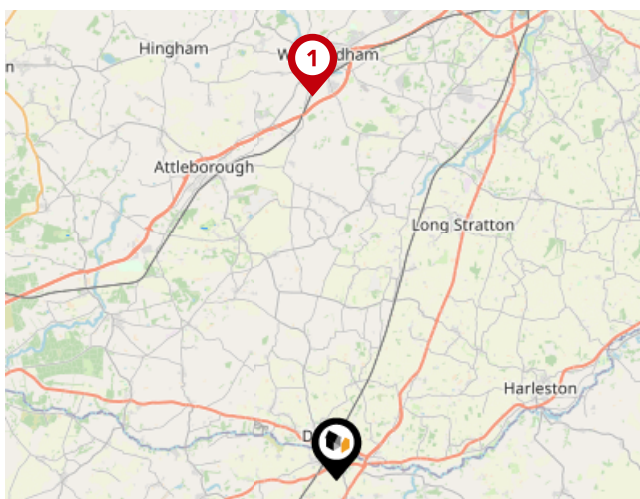

Local Connections

Pin	Name	Distance
1	Wymondham Abbey (Mid Norfolk Railway)	13.93 miles

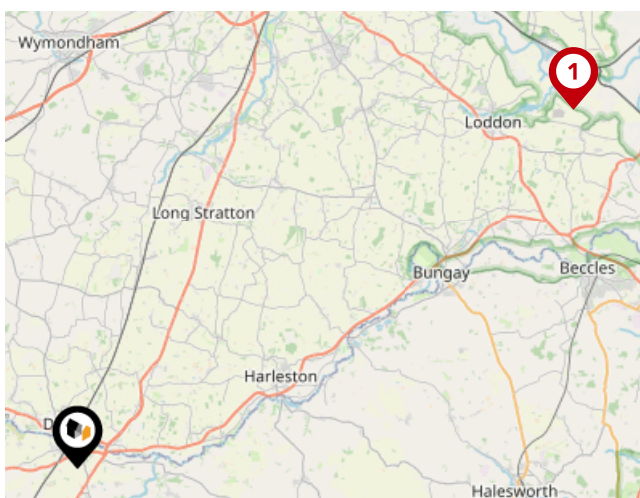

Ferry Terminals

Pin	Name	Distance
1	Reedham Ferry South	22.15 miles

Market

House Price Statistics



10 Year History of Average House Prices by Property Type in IP22

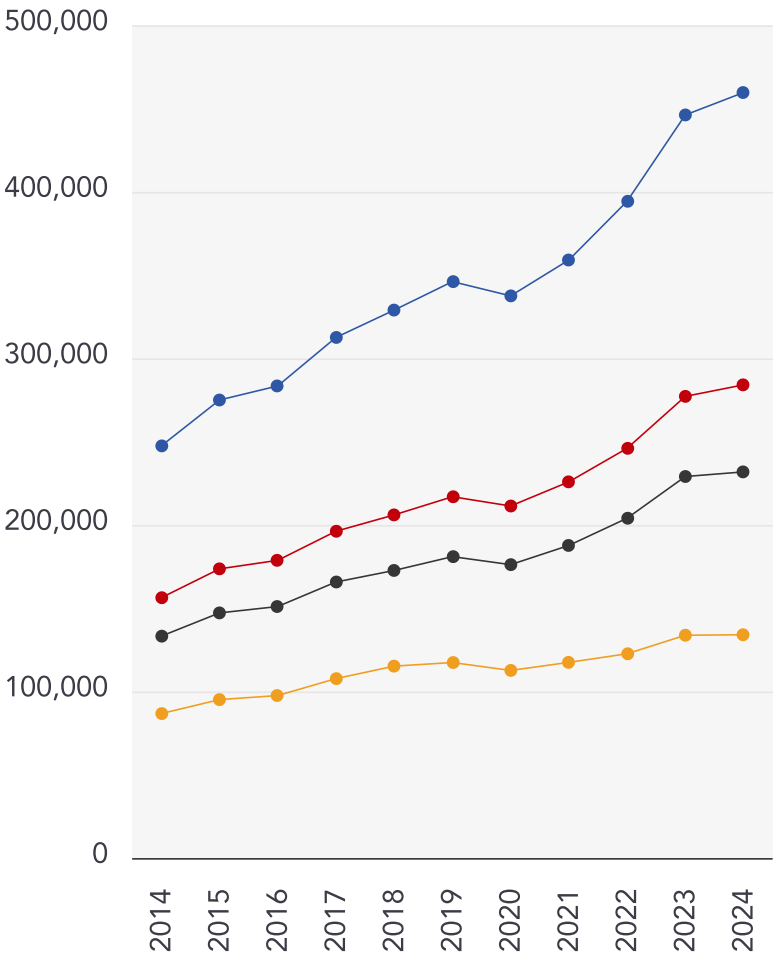

Detached

+85.73%

Semi-Detached

+81.75%

Terraced

+74.03%

Flat

+54.55%



Whittley Parish | Diss

At Whittley Parish, we strive to offer the best experience for all of our valued clients. We employ an experienced team and support our people with the best processes, cutting edge technology, marketing and training. We continue to improve and learn from feedback to strive to be the best at what we do and achieve.

Our proactive approach combined with advertising across four major property portals (Rightmove, Zoopla, onthemarket.com and Primelocation) as well as on social media platforms; coupled with our large database of registered applicants allows us to promote our properties to the widest target market.

With family roots still at the heart of all operations, Alex Parish ensures the original ethos and vision continues to run throughout the company's core, never comprising the personal service its reputation has been built upon.



Testimonial 1



It was a pleasure doing business with the Attleborough branch. Kept to every promise made and acted really fast. Made a stressful time far less stressful.

Testimonial 2



We asked Whittley Parish Diss to carry out a house valuation for us. Alex Parish came to do the job - he was kind, considerate and professional. The process was thorough but yet quick and easy for us. We couldn't ask for more - many thanks.

Testimonial 3



The whole team at Whittley Parish were first class from first introduction to final sale. With lots of estate agents in the Long Stratton area, this is the only one you need to know. Excellent would highly recommend.



[/whittleyparishmanagementltd](#)



[/whittleyparish](#)



[/whittleyparish/?hl=en](#)

Whittley Parish | Diss

Data Quality

We are committed to comprehensive property data being made available upfront to make the home buying and selling process quicker, easier and cheaper. This is why we have partnered with Sprift, the UK's leading supplier of property-specific data.



Contains public sector information licensed under the Open Government License v3.0

The information contained within this report is for general information purposes only and to act as a guide to the best way to market your property for the asking price.

Sprift Technologies Ltd aggregate this data from a wide variety of sources and while we endeavour to keep the information up to date and correct, we make no representations or warranties of any kind, express or implied, about the completeness, accuracy, reliability, of the information or related graphics contained within this report for any purpose.

Any reliance you place on such information is therefore strictly at your own risk. In no event will we be liable for any loss or damage including without limitation, indirect or consequential loss or damage, or any loss or damage whatsoever arising from loss of data or profits arising out of, or in connection with, the use of this report.



Whittley Parish | Diss

4-6 Market Hill Diss IP22 4JZ

01379640808

admin@whittleyparish.com

<https://www.whittleyparish.com/>

