



Thropp Close, Darwin Park, Lichfield
£415,000

3 2 2



This is one of the best three bedroom detached homes that you will see on the whole of the hugely desirable Darwin Park! Coming to the market impeccably appointed throughout and with a fabulous garden room extension to the rear, this is a very generous property sitting on an attractive and mature garden plot. The accommodation comprises an entrance hall with guest WC off, large living room and spectacular contemporary kitchen diner with a garden room to the rear. Upstairs are three good sized bedrooms and both a modern en-suite and bathroom. Outside is a driveway sitting in front of the garage, whilst to the rear is a very attractive mature garden plot which benefits from being very private, with a garden and patio accessed off the garden room. This is a must view property, so don't miss out and book in an early viewing!



ANDREW
DOWNING
BOOTH
ESTATE AGENTS



ANDREW
DOWNING
BOOTH
ESTATE AGENTS

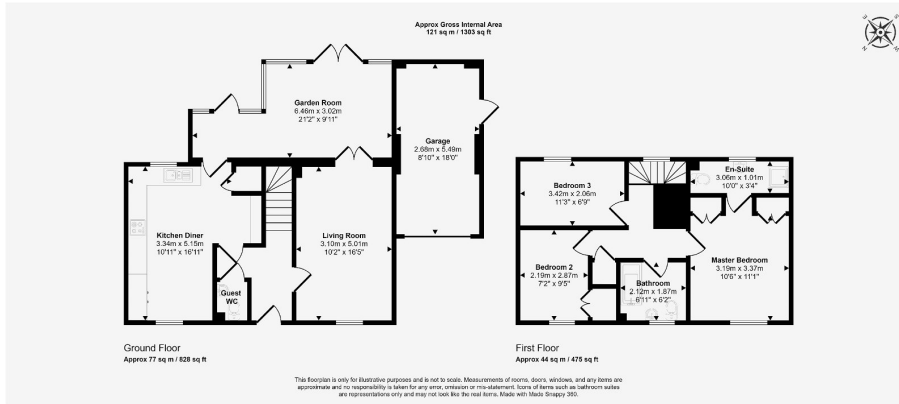

- Three Bedroom Detached Home
- Stunning Presentation Throughout
- Modern Bathroom, En-Suite & Guest WC
- Large Living Room & Garden Room Extension
- Stunning Contemporary Kitchen Diner
- Driveway, Garage & Attractive, Private Rear Garden

