



# Selwyn Road, Burntwood, WS7 9HU

£395,000

🛏️ 4 🚿 2 🚗 2



Four bedrooms, two bathrooms, two reception rooms and a stunning kitchen diner...try finding that amount of accommodation at this price anywhere else, and we think you might struggle! The property benefits from being beautifully appointed throughout and comes with no upward chain. Sitting with direct access off privately owned gardens which are impeccably maintained, this large four bedroom home has to be viewed in order to be appreciated. The accommodation comprises a through entrance hall with guest WC off, a large dual aspect living room, family room / study and fabulous contemporary kitchen diner with utility room off. Upstairs rare four bedrooms with the master boasting stunning en-suite facilities, whilst there is a family bathroom. Outside is a very attractive garden with large paved patio and lawned garden with shrub border. To the rear of the garden is a driveway sitting in front of the garage. So what's not to like?! This property ticks all of the boxes, so don't miss out and book in an early viewing!

### Note

Please note the property is accessed off gated private gardens which are maintained by a management company where there are six directors each being an owner of the six properties enjoying the access off the garden. The management fee for this garden area is approximately £120 per year.



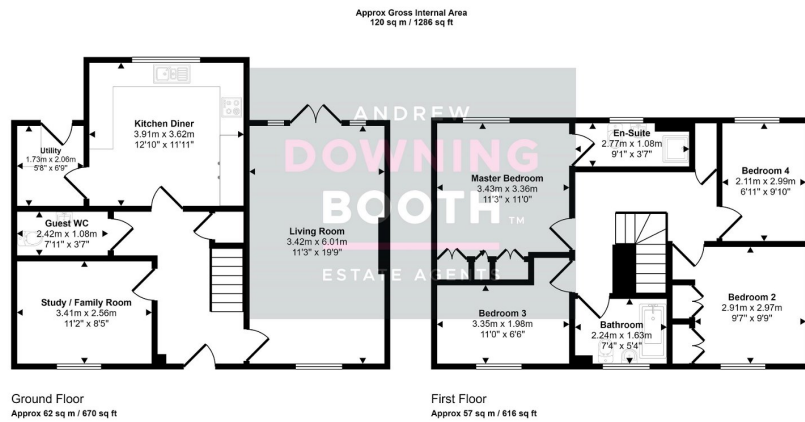

This floorplan is only for illustrative purposes and is not to scale. Measurements of rooms, doors, windows, and any items are approximate and no responsibility is taken for any error, omission or mis-statement. Icons of items such as bathroom suites are representations only and may not look like the real items. Made with Made Snappy 360.

- Four Bedroom End Of Terrace With Private Gated Gardens
- Large Living Room & Study / Family Room
- Guest WC, Bathroom & Fabulous Contemporary En-Suite
- Beautifully Appointed Throughout & No Upward Chain
- Stunning Kitchen Diner With Separate Utility
- Attractive Garden, Driveway & Garage

