





## Fecknam Way, Lichfield

Offers Over £400,000

🛏 4 🚿 2 🚗 3





A beautifully presented four bedroom home, offering fantastic living space whilst sitting in a popular part of Lichfield. This impressive semi-detached property in Fecknam Way comes to the market with plenty on offer, from the three separate reception rooms, to the fabulous Master bedroom with built in wardrobes and its own en-suite shower room.

The property benefits from nestling in a very convenient location, with the Imperial Retail Park within a five minute walk and Lichfield city centre just a mile away, with access to major supermarkets, Beacon Park and both Lichfield train stations, enjoying links to Birmingham, London and other surrounding areas.

The accommodation is set across two floors, with an entrance hall, attractive and separate living and dining rooms, a conservatory, stunning contemporary kitchen, utility room and guest WC all to the ground floor, whilst the four bedrooms (Master with en-suite) and main bathroom occupy the first. A spacious brick paved driveway and a garage is complimented by a generous and very well maintained rear garden to make up the property's exterior.





- Four Bedroom Semi-Detached Property
- Fabulous Master Bedroom With En-Suite & Built In Wardrobes
- Very Popular Location
- EPC Rating: TBC
- Beautifully Presented Throughout
- Living Room, Dining Room & Conservatory
- Driveway, Garage & Generous Rear Garden
- Council Tax Band: D

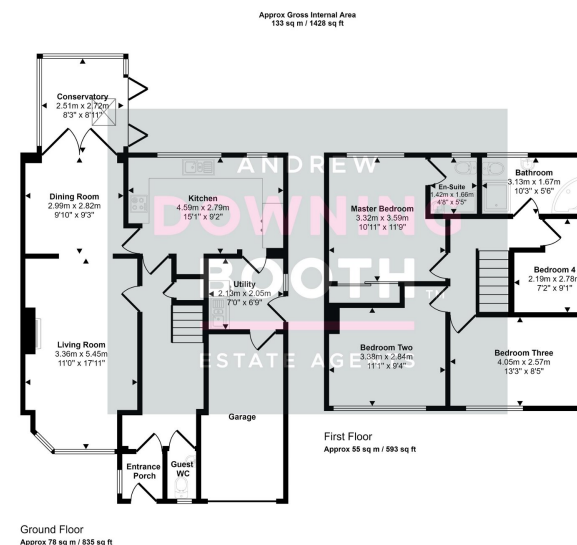

This floorplan is only for illustrative purposes and is not to scale. Measurements of rooms, doors, windows, and any items are approximate and no responsibility is taken for any error, omission or mis-statement. Icons of items such as bathroom suites are representations only and may not look like the real items. Made with Made Snappy 360.