



# DUNSLEY HALL FARM BARNES, Kinver, DY7 6LU

Offers In Region Of £785,000

4 3 2

- A stunning FOUR BEDROOM BARN CONVERSION.
- Close to the thriving Village, having plenty of local amenities, schools, scenic walks and Dining Room, modern Breakfast Kitchen, Reception Hall having a Beautiful Gardens to the side, providing access to the Garage.
- EPC Rating TBC.
- Idyllic COUNTRYSIDE SETTING within the prestigious Dunsley area of Kinver, oozing character, charm and offering modern living throughout, from exposed beams to vaulted ceilings, two having Ensuite Shower Rooms, Modern Family Bathroom, viewing is essential to appreciate the living accommodation on offer.



A stunning FOUR BEDROOM BARN CONVERSION occupying this IDYLLIC COUNTRYSIDE SETTING on the outskirts of Kinver in the prestigious Dunsley address. Oozing character and charm with a modern contemporary twist, boasting exposed beams, vaulted ceilings, a stunning central staircase, a Dining Room, large Living Room, modern Breakfast Kitchen, Two Ensuities, modern Bathroom and private Gardens to the side. An EARLY VIEWING IS ESSENTIAL to appreciate the living accommodation and countryside setting, having commuter links close by.



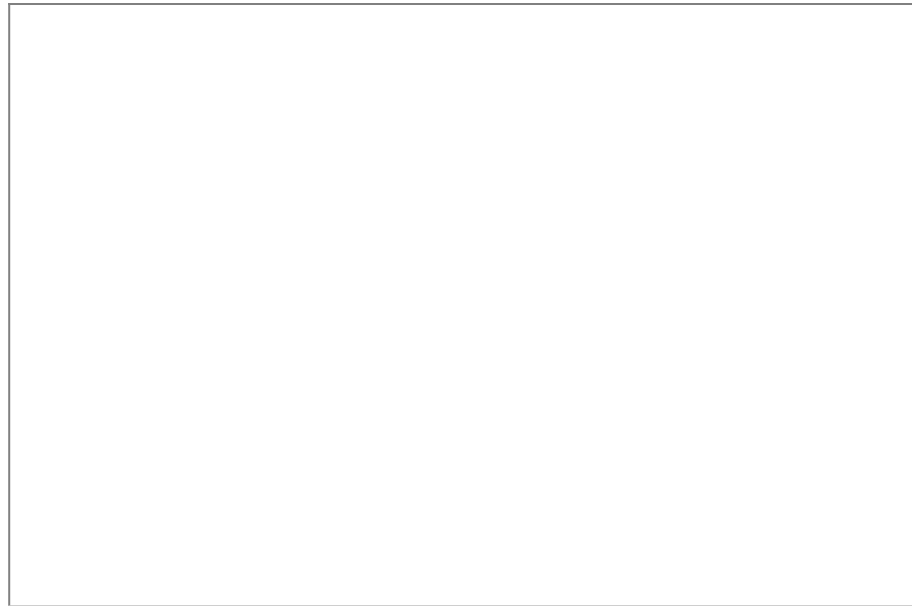
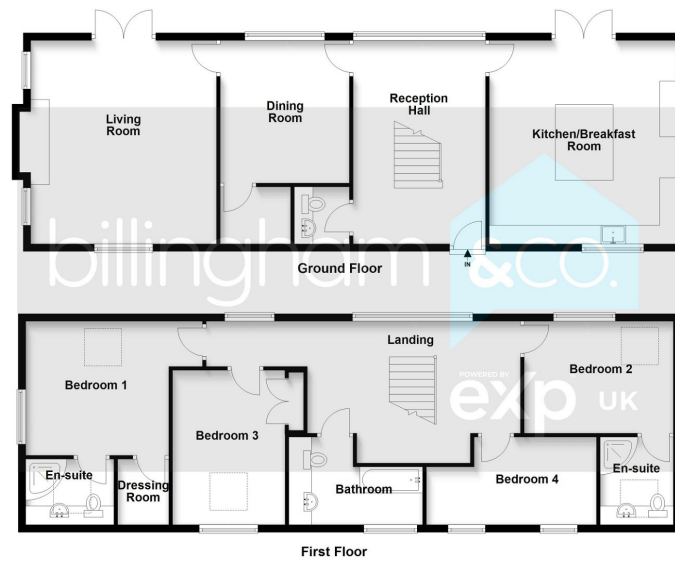

Sales 01384 444 004 / Lettings 01384 445 075  
 hello@billingham.properties  
 www.billingham.properties



Agents Note: Whilst every care has been taken to prepare these particulars, they are for guidance purposes only. All measurements are approximate and are for general guidance purposes only and whilst every care has been taken to ensure their accuracy, they should not be relied upon and potential buyers are advised to recheck the measurements.