

Knyvett Green, Ashwellthorpe, Norwich, NR16 1HA

Offers In Region Of £395,000

3 1 2



- Immaculate detached three bedroom bungalow
- Sitting on a generous 90ft x 55ft plot with field views to the rear
- Garden room / home office 13ft 3in x 8ft 4in
- Minutes from the Norfolk market towns of Wymondham and Attleborough with all their amenities
- Well placed for the railway stations at Diss, Wymondham and Attleborough with regular services
- Offering approximately 1200 sq ft of living space
- Shingled front garden allowing parking for three / four cars
- Close to sought after schools and village amenities
- Easy access to the main A11 for those commuting to Norwich and Cambridge for work
- Motivated sellers looking to move closer to family in the south

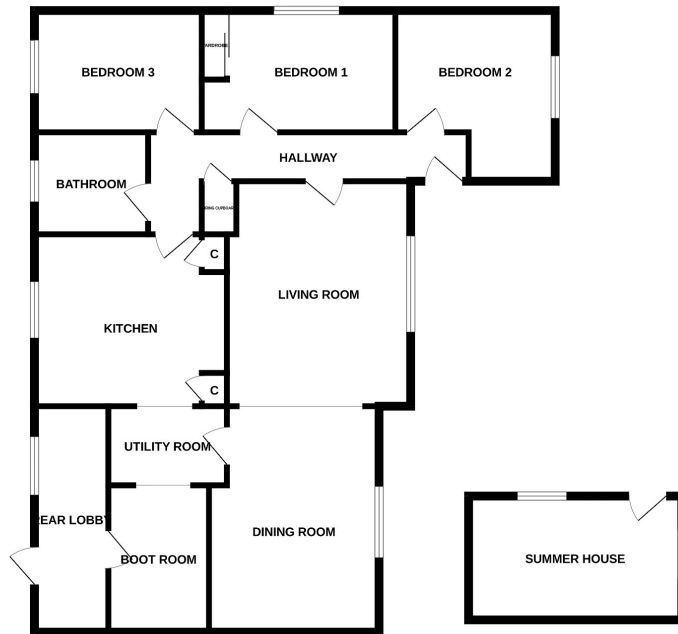

Whilst every attempt has been made to ensure the accuracy of the description contained herein, measurements of doors, windows, rooms and any other items are approximate and no responsibility is taken for any error, omission or misstatement. This plan is for guidance purposes only and should be used as such by any prospective purchaser. The services, systems and appliances shown have not been tested and no guarantee is given as to their operability or efficiency on the date.

MONEYPROPERTIES ARE DELIGHTED TO OFFER THIS IMMACULATE AND WELL PRESENTED DETACHED THREE BEDROOM BUNGALOW OFFERING APPROXIMATELY 1200 SQ FT OF LIVING SPACE. The property sits on a generous plot 90FT X 55FT, and can be found in a sought after Norfolk village at the bottom of a quiet cul de sac, only minutes from the Norfolk market towns of Wymondham and Attleborough with all their amenities. This detached bungalow has been well maintained and comprises of entrance hall, 13ft 7in living room, kitchen, bathroom and three double bedrooms, the garage has been converted to provide dining room, utility room and rear lobby.