



18 Pear Lane, Plympton, Plymouth, PL7 2GB



Price £295,000



Nestled in the desirable area of Plympton, Devon, this elegant three-bedroom end-terrace house is thoughtfully arranged over three floors. The property boasts a spacious master bedroom with a large en-suite and built-in storage, alongside two additional double bedrooms connected by a stylish Jack and Jill bathroom.

The heart of the home features a well-appointed kitchen and a welcoming lounge/diner, complete with bay windows that overlook the charming enclosed rear garden with a lovely outlook. Additional features include a convenient cloakroom, two parking spaces, and a layout that offers both comfort and practicality, making it an ideal choice for families or those seeking a refined living space.



This property is well positioned to take advantage of the open parkland and the excellent range of amenities close-by include a local doctor's surgery, Chaddlewood shopping precinct and regular transport links to the Ridgeway Shopping Centre together with easy access to the A38.

The development is run by a management company and there is a yearly charge of £170 for the maintenance and upkeep of the estate. The details of which should be confirmed by your solicitor.

To view this property call Lang Town & Country Estate Agents on **01752 456000**.



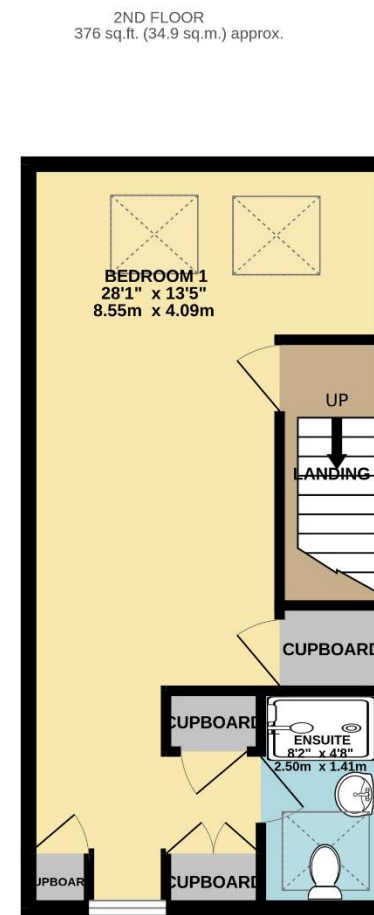
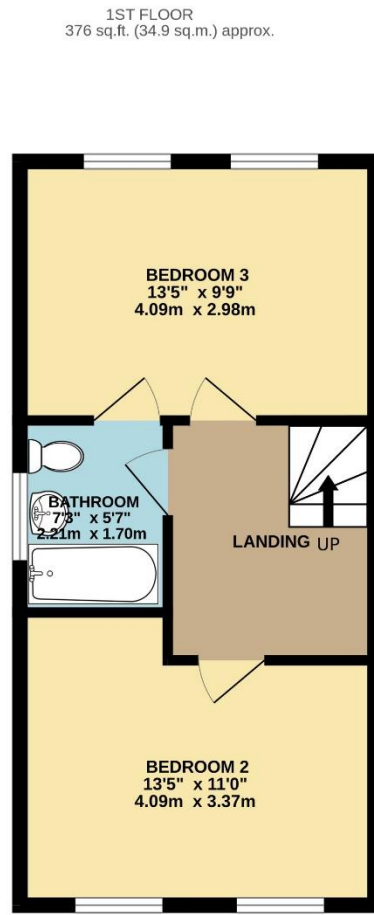
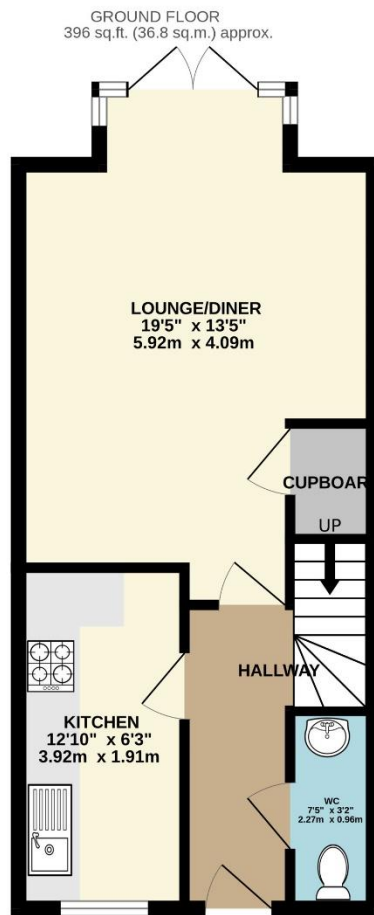

TOTAL FLOOR AREA : 1149 sq.ft. (106.7 sq.m.) approx.
Measurements are approximate. Not to scale. Illustrative purposes only
Made with Metropix ©2024



Lang Town & Country
6 The Broadway
Plymstock
Plymouth
PL9 7AU
Tel: 01752 456000
Email: plymstock@langtownandcountry.com
www.langtownandcountry.com

Lang Town & Country endeavour to ensure the accuracy of property details produced and displayed, we have not tested any apparatus, equipment, fixtures, fittings or services and so cannot verify that they are connected, in working order or fit for purpose. A buyer must check the availability of any property and make an appointment to view before embarking on any journey to see a property.

