



Sutherland Avenue, Maida Vale W9

£695,000

 2  1  1



- Super stylish fully renovated 2-bed top-floor apartment
- An abundance of storage in the flat and loft
- Homely modern kitchen and cosy living room with fireplace
- Close to a range of local shops, cafes, and restaurants of Maida Vale, Little Venice, Notting Hill
- Share of Freehold, SC £1200 per annum, GR Peppercorn, Council tax band E
- Terrace which enjoys a wonderful outlook over the London rooftops and skyline
- Loft demised and can be developed
- Gives a sense of space and charm with natural sunlight throughout
- A short walk away from Paddington Recreation
- Please watch the video and quote Property Ref LL0089 to book a viewing

Sutherland Avenue, W9 2QS

Approx Gross Internal Area = 57 sq m / 613 sq ft
 Loft = 49 sq m / 527 sq ft
 Total = 106 sq m / 1140 sq ft

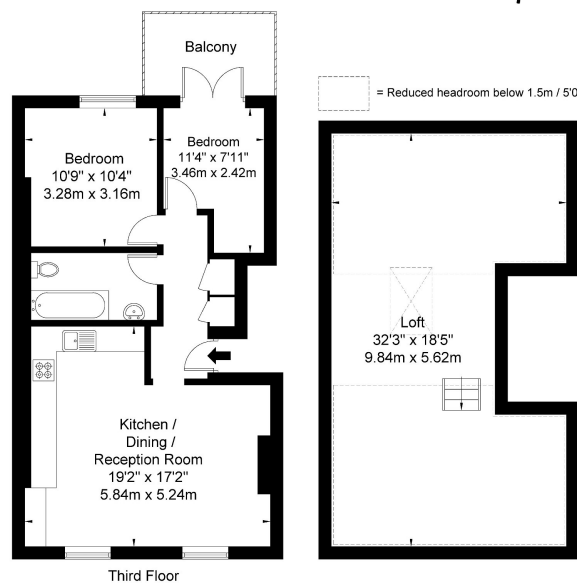

Third Floor

Ref

Copyright **BLEU**
PLAN

The Floor plan is not to scale and measurements and areas shown are approximate and therefore should be used for illustrative purposes only. The plan has been prepared in accordance with the RICS code of Measuring Practice and whilst we have confidence in the information produced it must not be relied on. If there is any aspect of particular importance, you should carry out or commission your own inspection of the property.
 Copyright © BLEUPLAN

A super stylish 2-bed top-floor apartment with a loft and terrace, in an attractive stucco-fronted conversion, a short stroll away from the heart of Maida Vale, Little Venice, Notting Hill, and Golborne Road.

Please watch the video and quote Property Ref LL0089