

Ash Grove, NW2

£575,000

🛏 2 🚿 1 🚗 1



- A superb two bedroom garden apartment
- Mature garden with BBQ area
- Unique central courtyard with stylish double doors
- Recently renovated to a high standard including a brand new kitchen with new appliances
- A walk or short bus journey to Kilburn or Willesden Green tube stations, both on the Jubilee line
- Professionally sound proofed
- Eye catching and well equipped kitchen
- Close to West Hampstead, Willesden Green and The Mapesbury Conservation Area.
- Long lease and low maintenance costs
- Please quote property ref LL0089

Ash Grove NW2

Approx. Gross Internal Area = 69.6 sq m / 749 sq ft

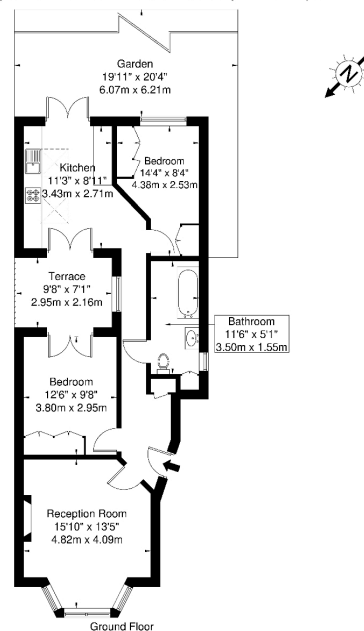

Ref

Copyright

**BLEU
PLAN**

The Floor plan is not to scale and measurements and areas shown are approximate and therefore should be used for illustrative purposes only. The plan has been prepared in accordance with the RICS code of Measuring Practice and whilst we have confidence in the information produced it must not be relied on. If there is any aspect of particular importance, you should carry out or commission your own inspection of the property.
Copyright © BLEUPLAN

A superb two bedroom garden apartment in a period building on Ash Grove in NW2, close to West Hampstead, Willesden Green and The Mapesbury Conservation Area.

Boasting elegant décor, this fantastic two bedroom apartment is presented in immaculate condition and enjoys well planned living space. On entry the hallway provides access to a

comfortable living room which boasts plenty of space for relaxing and an abundance of natural light streaming through the sash bay windows with in-built storage.

The main bedroom overlooks the unique courtyard which also enjoys double doors into the eye catching and well equipped kitchen. This super flat is completed by a further bedroom, stylish bathroom and mature garden with BBQ area.