

## Bath Terrace, SE1

£2,350PCM (Deposit: £2,711)

🛏 2 🪑 1 🚿 1



Tax Band: F

Furnished: Furnished

- Spacious two double bedroom apartment
- Brand new development
- A short walk away from Elephant and Castle tube station
- Excellent links into the City and Canary Wharf
- Fully-fitted kitchen
- Open plan living space
- Private terrace
- Large double glazed windows
- Shops and restaurants on your doorstep
- A short walk from Borough Market

### Bath Terrace SE1 6PS

Approx Gross Internal Area = 60.5 sq m / 651 sq ft

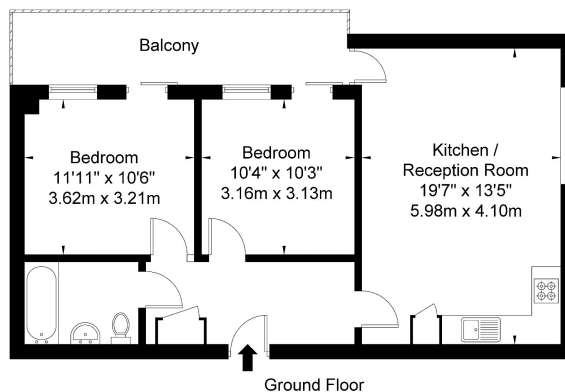

Ref

Copyright **BLEU**  
**PLAN**

The Floor plan is not to scale and measurements and areas shown are approximate and therefore should be used for illustrative purposes only. The plan has been prepared in accordance with the RICS code of Measuring Practice and whilst we have confidence in the information produced it must not be relied on. If there is any aspect of particular importance, you should carry out or commission your own inspection of the property.  
Copyright © BLEUPLAN

A spacious two double bedroom apartment located on the ground floor of a brand new development a short walk away from Elephant and Castle tube station. The property is only a short walk from Borough Market and the River and boasts excellent links into the City and Canary Wharf.

This modern apartment has been finished to a good standard with a fully-fitted kitchen, neutral décor and large double glazed windows. Access to the private terrace is through the open plan living space as well as through the bedrooms.

Elephant and Castle has fantastic transport links with two tube lines, the overground and a huge amount of bus options. It's also within walking distance of Borough and London Bridge as well as Waterloo and the South Bank. There are shops and restaurants on your doorstep and the changing nature of the area means there are new amenities opening all the time.