

whiteley helyar



425 ft²



2 bedrooms



shower room



permit
parking

Guide Price £325,000

Flat 4, 16 James Street West, Bath, BA1 2BT

Flat 4, 16 James Street West, Bath, BA1 2BT

A bright and well-presented two double bedroom first floor apartment built in 2007 positioned in this prime city centre location close to amenities. Currently run as a successful holiday let (figures available on request) this fantastic investment property is available chain free and can be sold with all furniture and advanced bookings by separate negotiation.

ACCOMMODATION

kitchen
sitting / dining room

two double bedrooms
shower room

LOCATION

James Street West occupies a convenient and popular position close to Sainsbury's supermarket and within easy strolling distance of the shops, amenities and Railway station in Bath. The property is also ideally placed for access to the river and Bristol and Bath Cycle Path affording easy access to the countryside.





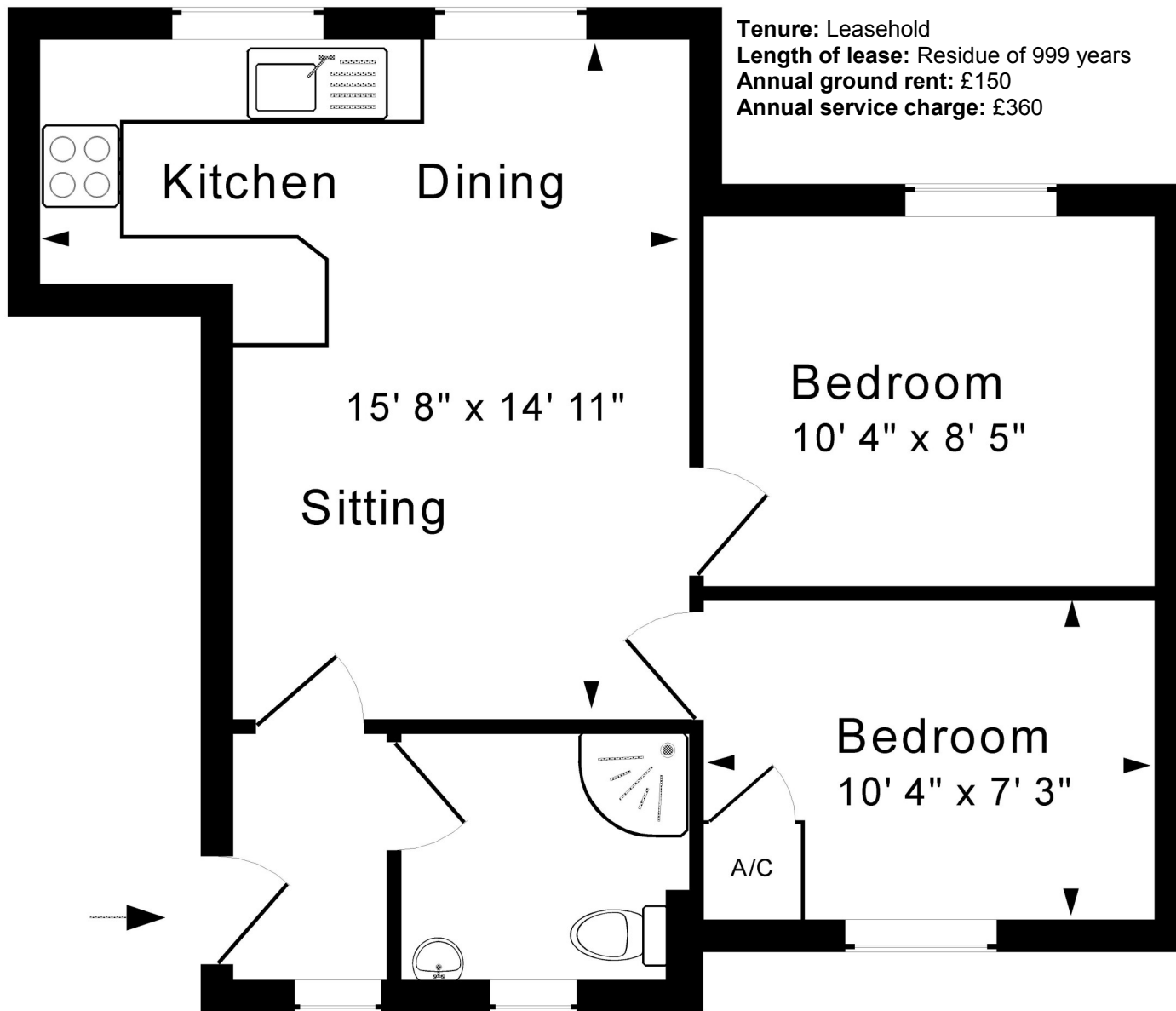

Approx. Gross Internal Floor Area 425 Sq. Ft. / 40 Sq. M
 Includes Conservatories. Excludes Garages, Porches etc. unless stated
 For identification purposes only. Not to scale. Copyright Jemesis Ltd 2022
 Drawing Number: 172-0647
 Flat 4, 16 James Street West, Bath, BA1 2BT.

