

# whiteley helyar



595 ft<sup>2</sup>



double bedroom



bathroom



residents parking

Guide Price                      £285,000

Flat 4, 20 Paragon, Bath, BA1 5LX



A wonderful top floor apartment, with panoramic views, located right in the heart of the city. A spacious entrance hall offers good storage, along with a cupboard housing the washing machine, whilst the principal rooms are both a lovely size, with the contemporary kitchen open to the reception space. No onward chain.

## ACCOMMODATION

entrance hall with two storage cupboards  
double bedroom

sitting/dining room with fabulous panoramic view  
contemporary bathroom

bespoke kitchen with views

## LOCATION

The apartment occupies a superb location in a popular Georgian terrace, most conveniently located just a couple of minutes walk from Milson Street, in the very centre of Bath. The extensive range of shops, amenities, parks, sports facilities and transport links are within easy walking distance.









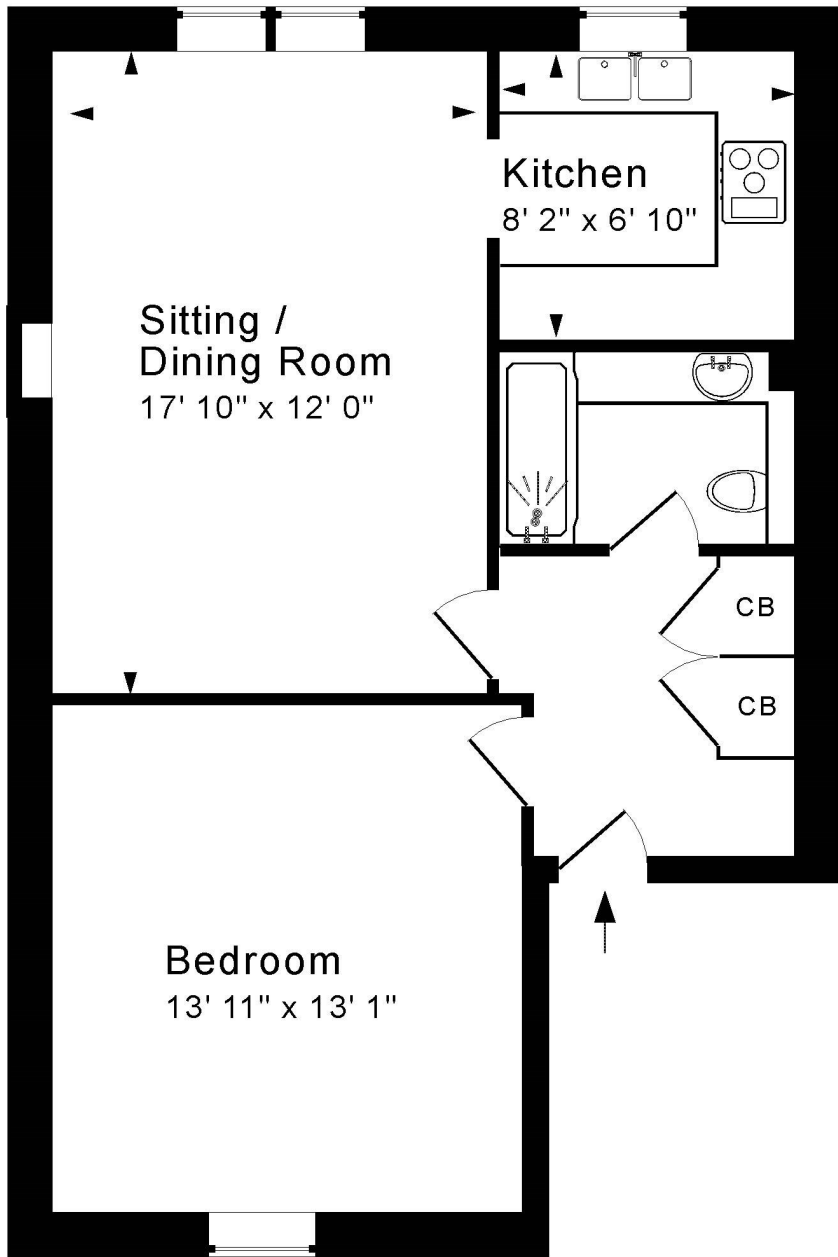

### Third Floor

Approx. Gross Internal Floor Area 595 Sq. Ft. / 55 Sq. M  
 Includes Conservatories. Excludes Garages, Porches etc. unless stated  
 For identification purposes only. Not to scale. Copyright Jemesis Ltd 2024  
 Drawing Number:172-0745  
 Flat 4, 20 The Paragon, Bath, BA1 5LX.

**Council Tax Band:** 'B' - £1,638.83  
**Tenure:** Leasehold - 215 yrs from 1989  
**Service charge:** £1,562.00