



we are
morfittsmith

251 Middlewood rd
Hillsborough,
Sheffield,
S6 4HE



A rare find is this three bedroom detached home opposite Hillsborough park and close to shopping facilities, bus routes and the supetram. ideal for the family wanting to create their forever home.





Why You'll Love It

Middlewood Road: A lovely three bedroom detached home directly opposite Hillsborough Park and ideal for the discerning purchaser to adapt to their own style and tastes. Entered into the front entrance porch which leads in turn to the inviting entrance hallway. There are two good reception rooms the one to the front ideal for a snug lounge with a broad bay window enjoying natural light and taking advantage of wooded views of Hillsborough Park. The reception to the rear could be enlarged into the kitchen and maybe also extended to the rear subject to the usual consents. To the first floor are three generous bedrooms two of which enjoy views of Hillsborough Park and the first floor is complimented by a bathroom and a separate w.c. Gardens are enjoyed to both front and rear. No Chain Involved - Early Completion Available.







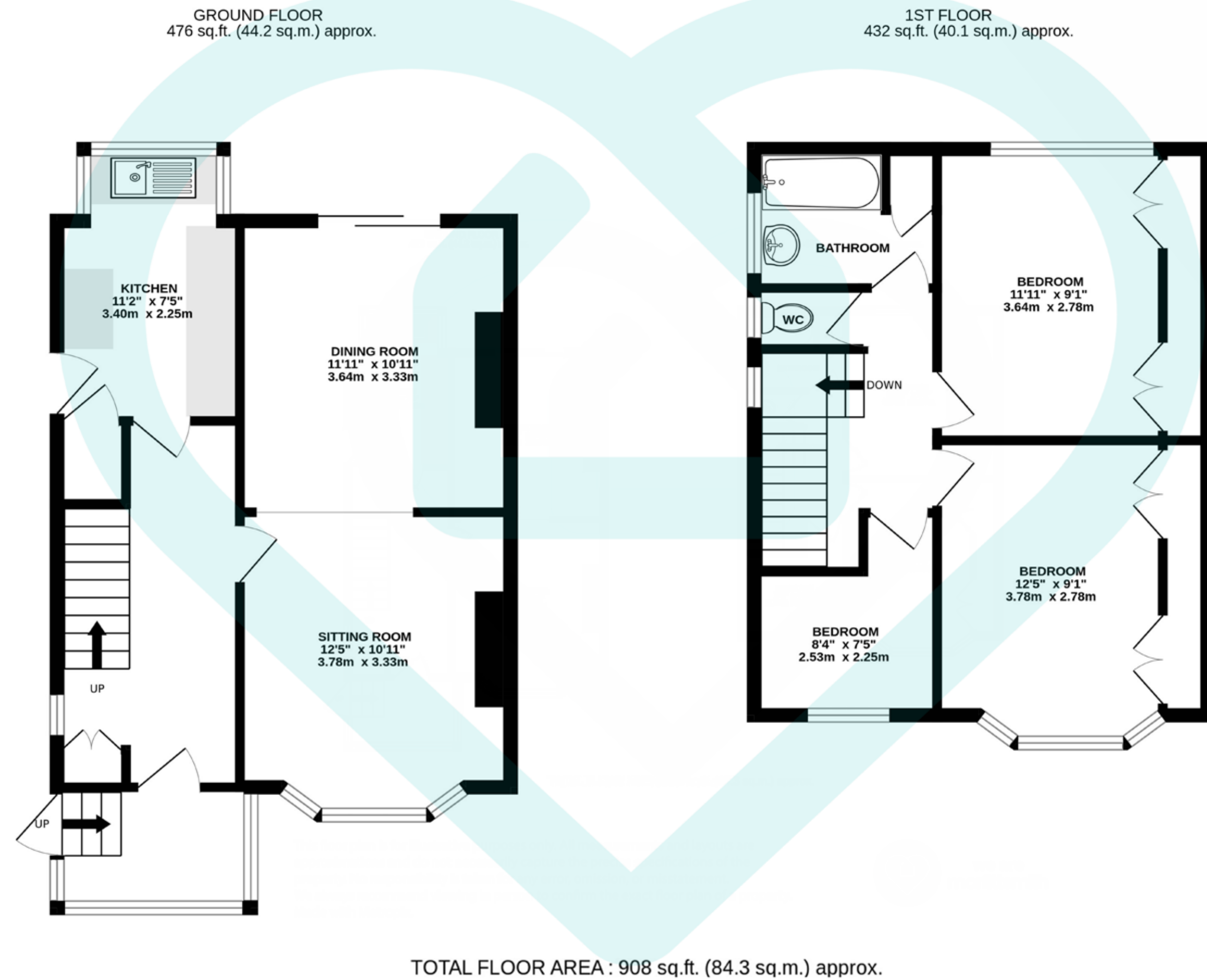

This floor plan is for illustrative purposes only. All measurements and layouts are approximations and do not necessarily capture the precise specifications of the property. No responsibility is taken for any error, omission, or misstatement. We always recommend viewing in person to confirm the exact floor plan of a property. Made with Metropix.





The MorfittSmith Building,
67 Middlewood Road,
Sheffield, S6 4GX



0114 232 1764



www.morfittsmith.co.uk



sales@morfittsmith.co.uk



lettings@morfittsmith.co.uk



newhomes@morfittsmith.co.uk



@morfittsmith



@morfittsmith



MorfittSmith Estate & Letting Agent



morfittsmith



sales | lettings | new homes
