

DAVID CHARLES

ESTATE AGENTS • VALUERS • SURVEYORS
THE ESTATE OFFICE • 34 HIGH STREET • PINNER • MIDDLESEX HA5 5PW
TELEPHONE 020 8866 0222 • FAX 020 8868 3544
WEBSITE www.david-charles.co.uk • E-MAIL enquiries@david-charles.co.uk

HIGH STREET, NORTHWOOD, MIDDLESEX, HA6 1BL



PRICE ... £1,450 PCM UNFURNISHED

A well presented first floor two bedroom flat (737 sq.ft/68.5 sq.m) is ideally located on the Old High Street in Northwood within walking distance to local shops and transport facilities and is within half a mile of Northwood town centre with its array of shops, restaurants, coffee house, Waitrose Supermarket and the Metropolitan Line Train Station gives swift access to Central London. The accommodation comprises of a communal entrance with stairs leading to the first floor landing with own door to a 15'2ft reception room with a feature brick fireplace, 13'10ft an 'eat in' kitchen, two bedrooms and a bathroom. The property is offered Unfurnished and is available from 18th March (Subject to References).







COUNCIL TAX

London Borough of Hillingdon Council Band D - £1,760.46

LOCAL SCHOOLS

- Frithwood Primary School - 0.45 Miles
- Northwood High School - 0.70 Miles
- St John's School - 1.20 Miles

LOCAL TRANSPORT

- Northwood Station (Metropolitan Line) - 0.6 miles
- Northwood Hills Station (Metropolitan Line) - 0.7 miles
- Pinner Station (Metropolitan Line) - 2.1 miles

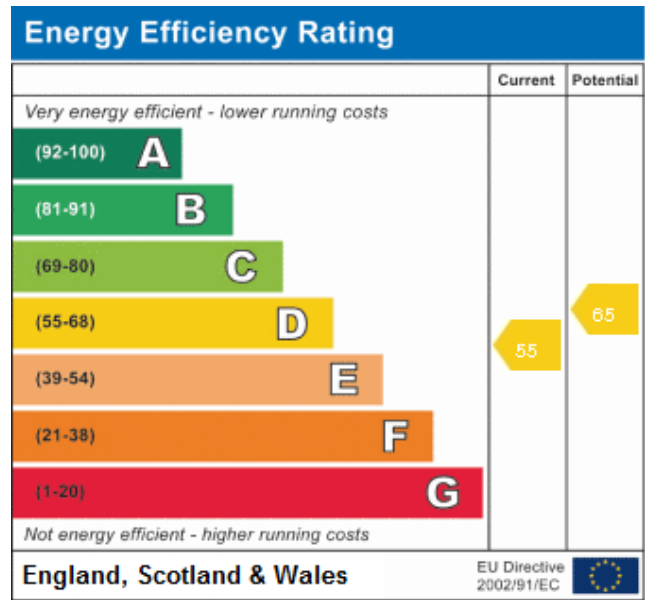

High Street

Approximate Gross Internal Area
Ground Floor = 1.6 sq m / 17 sq ft
First Floor = 68.5 sq m / 737 sq ft
Total = 70.1 sq m / 754 sq ft

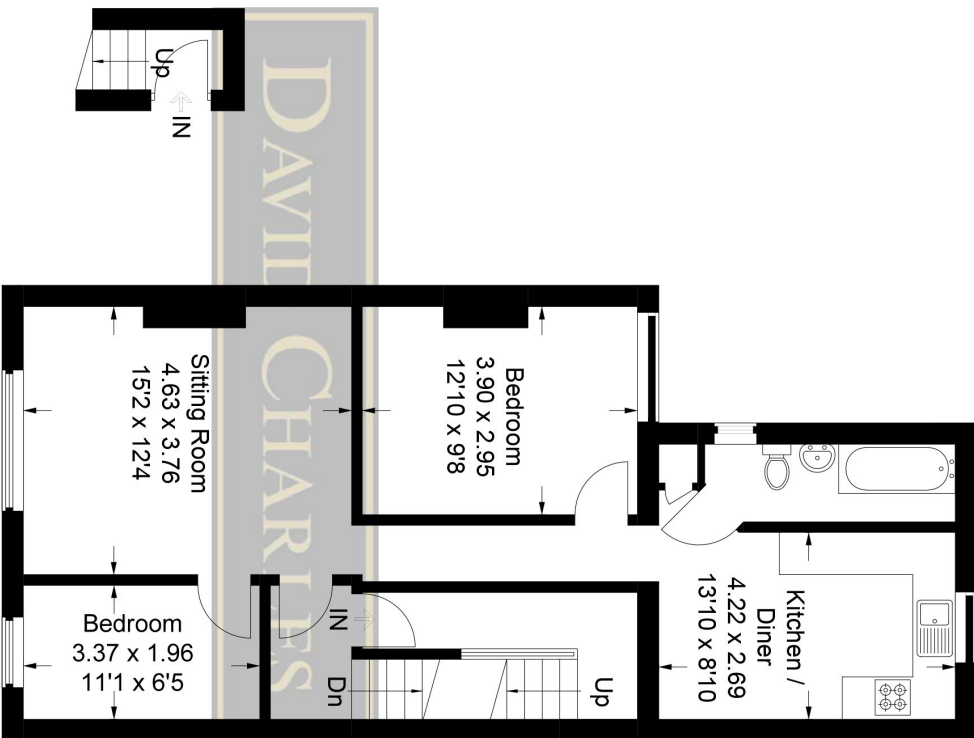

Ground Floor

First Floor

This plan is for layout guidance only. Not drawn to scale unless stated. Windows and door openings are approximate. Whilst every care is taken in the preparation of this plan, please check all dimensions, shapes and compass bearings before making any decisions reliant upon them.

© CJ Property Marketing Ltd Produced for David Charles



For appointments to view please call David Charles 020 8866 0222

All measurements are taken manually and whilst every care is taken with their accuracy they must be considered approximate and should not be relied upon when purchasing carpets or furniture. No responsibility is taken for any error, omission or misunderstanding in these particulars which do not constitute an offer or contract. Services and appliances have not been tested and therefore no warranty is offered on their operational condition.